

INCLUDES: 2-SIDED SHOWERS AND 3-SIDED ALCOVE DOORS

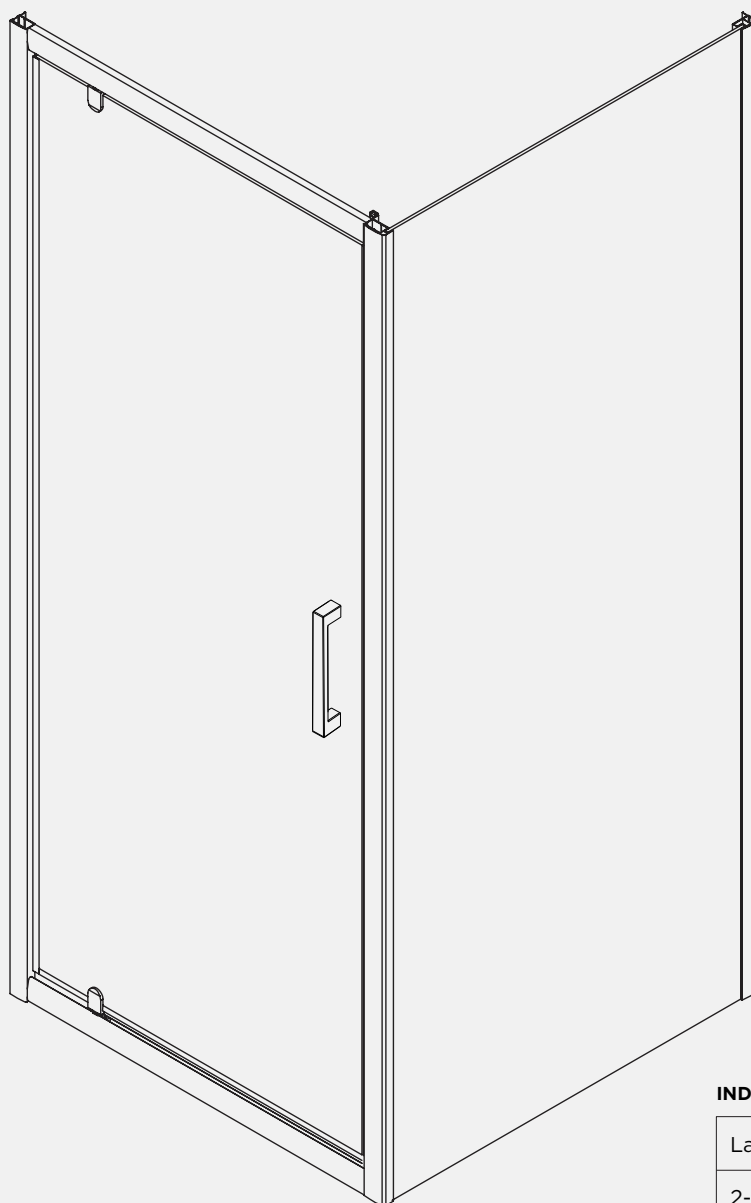

INDEX	PAGE
Lay-Out 2-Sided	4
2-Sided Shower	5-7
3-Sided Shower	9-12

## Important

1. When you receive your product check the contents for any freight damage or defects.
2. If this is a custom order, the size will be on the outside of the box. Check that it is correct.
3. Advise Marni on 0800 4 MARNI if any damage has occurred or if you have any questions about the size within 8 hours of receiving the goods so this can be rectified.
4. Do not install faulty products, as this will void your warranty.



## Health and Safety

- Unpack glass, stand on soft packing on floor and walls prior to assembly.
- Do not rework glass panels.
- Do not strike an edge or corner of glass.
- Use two persons where heavy glass lifting is required.
- Wear appropriate protective clothing and eye protection during installation.
- Mark gas/water pipe and electrical wire locations to ensure these are not touched.



## Attention

- **The tray base** must be installed level as this affects all shower alignments.
- **Wall Specifications** require a max variation of 3mm within shower height.  
Installer must check the viability of install if outside of these specs.
- **3-Sided Alcove Showers:** Wall must be accurate, straight, and plumb. Refer pre-install guide.
- **Double studs for solid fixing of wall channels:** Positioned at tray outside edge



## Tools Required

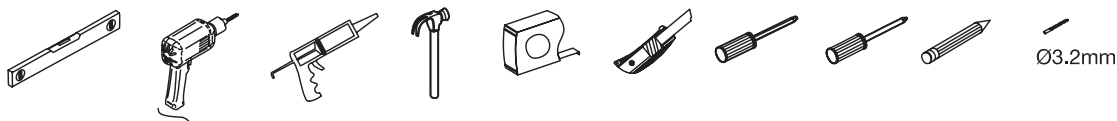

## Warranty

- This covers faulty goods but not breakages. Visit [marni.nz](http://marni.nz) for information.
- Compliance with Specs and these instructions are essential for a valid warranty.

**We recommend a skilled tradesman acquainted with shower installations to ensure the very best outcome.**

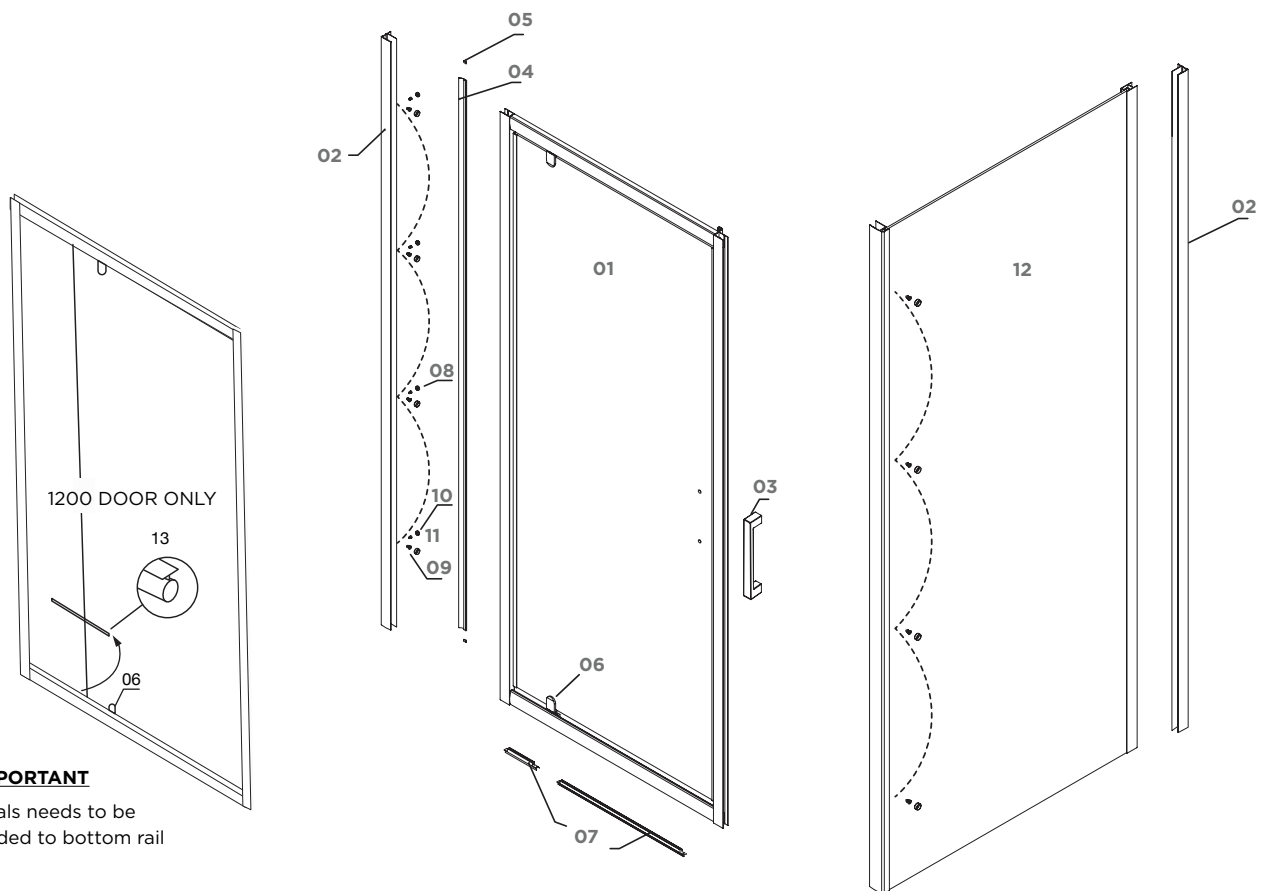

## COMPONENTS LIST

REFERENCE	DESCRIPTION	PART NUMBER	QUANTITY
1	Door Panel		1
2	Wall Channels	K7119*	2
3	Handle	H1263*	1
4	Back of Door Seal	K7072	1
5	Back of Door Seal Stop	K4000	2
6	Pivot Block	K2004	2
7	Under Door Seals	K6068	2
8	Wall Plug	Screw Pack F4163*	1
9	Screws-8x6 gauge x 38mm long		
10	Screw Caps		
11	Screws-8x6 gauge x 8-12mm long		
12	Return Panel		1
13	Fixed Panel Seal (1200 Only)	I2728	1

\*Add .CR for Chrome Code .WH for White Code, .BK for Black Code

## SHOWER & TRAY LAYOUT TABLES

1. Identify the Shower and Tray size you are installing.
2. Table A & B distinguished Lay-out off tray edge for each type of Acrylic Tray.
3. The Door-Set can use shared adjustment: (Wall and corner post).
4. **Note.** Where wall adjustments are small check these walls for plumb before you plot your best position.

**Note:** Alcove Shower Table Page 9

### TABLE A: STANDARD PROFILE TRAY 65MM HIGH

	DOOR SET TRAY SIZE	CORNER POST ADJUSTMENT	WALL ADJUSTMENT	RETURN PANEL TRAY SIZE	WALL ADJUSTMENT	TRAY EDGE TO WALL CHANNEL
1	750mm	0	4	900mm	4	13mm
2	900mm	0	4	750mm	4	13mm
3	900mm	0	4	900mm	4	13mm
4	1000mm	0	4	1000mm	4	13mm
5	1200mm	3	6	900mm	4	13mm

**NOTE:** Make sure the correct shower is used on the correct tray.

### TABLE B: MIN TO MAX PIVOT SHOWER RANGE

	DOOR & RETURN	DOOR SET	RETURN PANEL
1	750mm x 900mm	Min 720mm - Max 740mm	Min 870mm - Max 888mm
2	900mm x 750mm	Min 870mm - Max 890mm	Min 720mm - Max 738mm
3	900mm x 900mm	Min 870mm - Max 890mm	Min 870mm - Max 888mm
4	1000mm x 1000mm	Min 970mm - Max 990mm	Min 970mm - Max 988mm
5	1200mm x 900mm	Min 1165mm - Max 1185mm	Min 870mm - Max 888mm

Walls out of plumb will not allow for full MIN to MAX options.



1

Walls out of plumb will not allow for full minimum / maximum options.

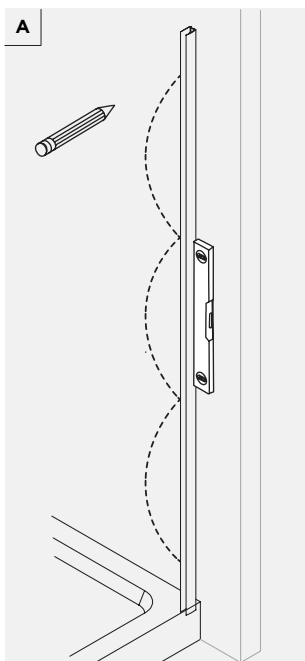
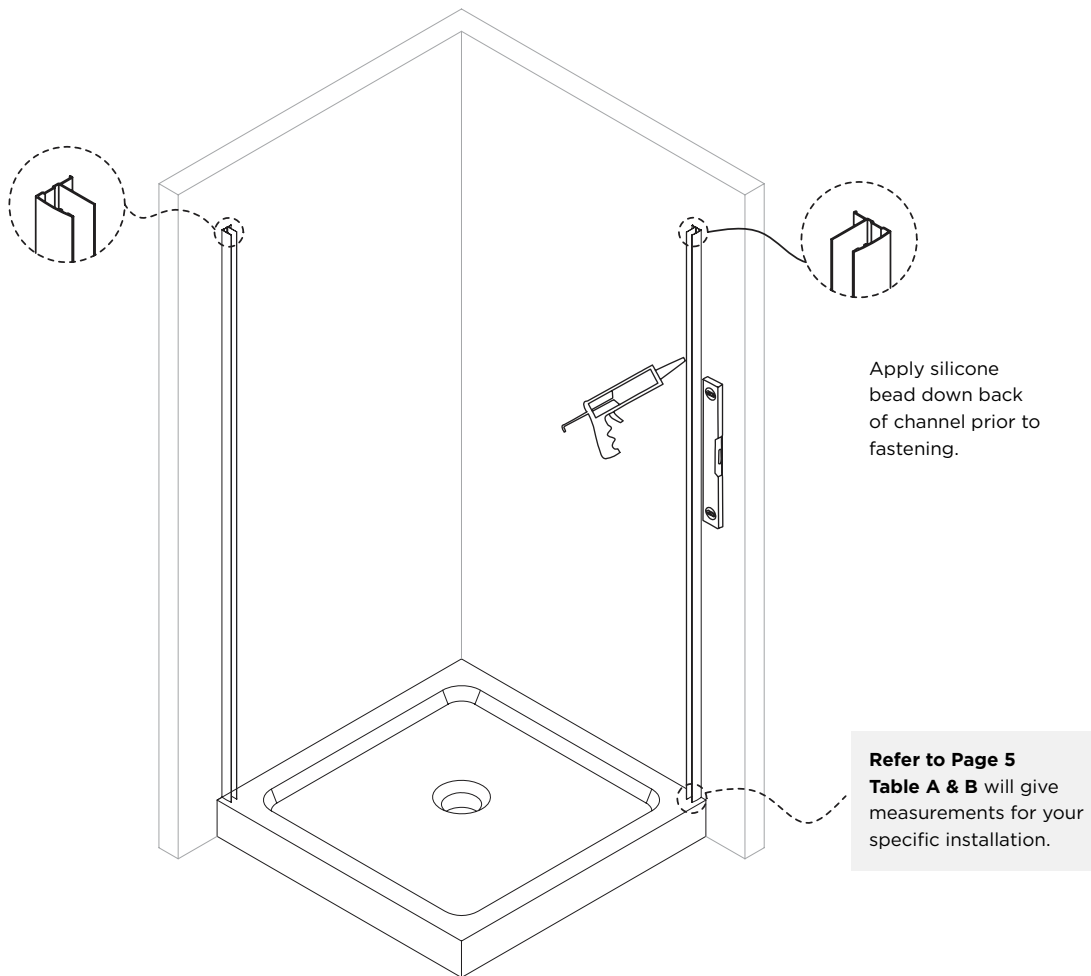

Mark Wall Profile

### Acrylic Shower Lay-out

Ensure you read section on page 5.

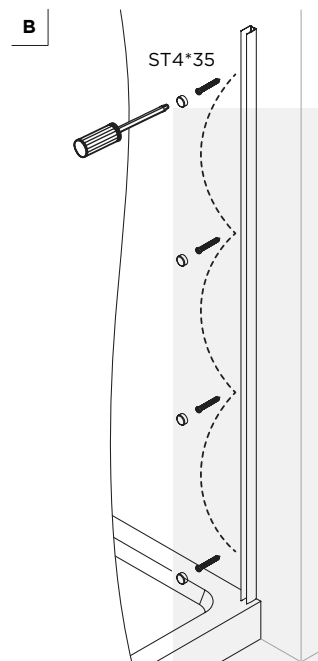

Fasten wall profiles for return and door panels.

2

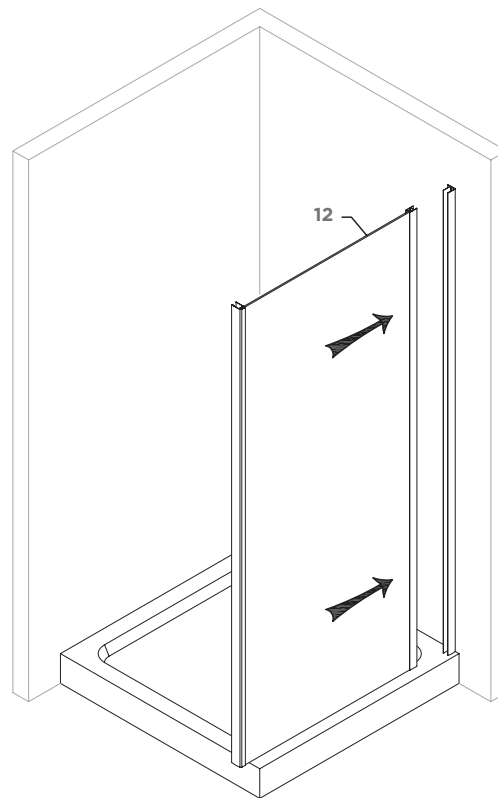

Fit return panel.

3

### 1200 DOOR-SET INCLUDES A FIXED GLASS PANEL

Drawing on page 3 of Components List

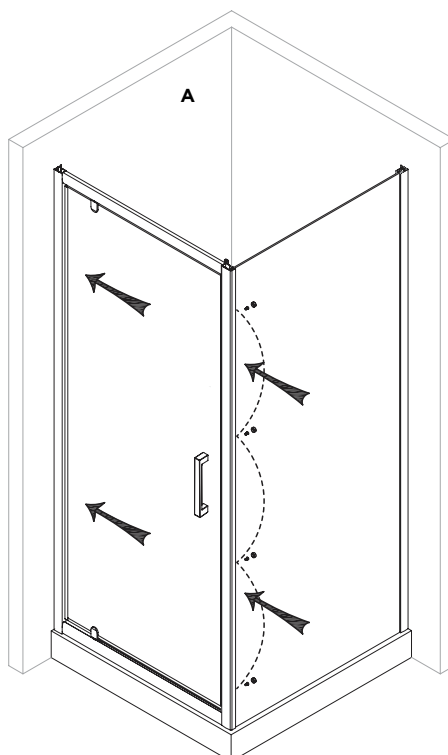

**A**  
Connect door set to  
return panel.

**NOTE:** Table on page  
5 will show suggested  
corner post position for  
your specific shower  
install.



Corner post must be  
plumb & parallel to the  
door side channel.  
This effects Alignment  
of magnetic door seal.

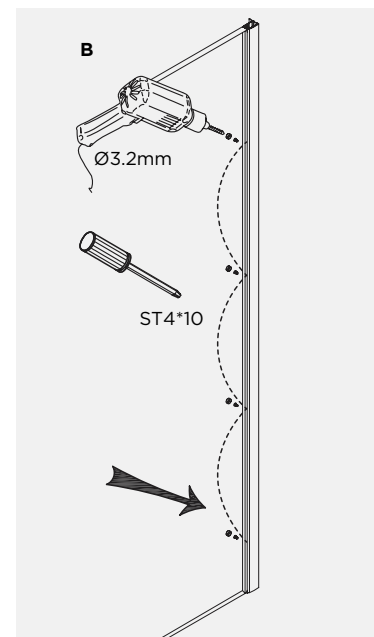

- B**
- Finally adjust shower door in wall profiles and square up door to frame.
  - Drill and fasten door frame and return panel to wall profiles.

4

Apply silicone to join as indicated.

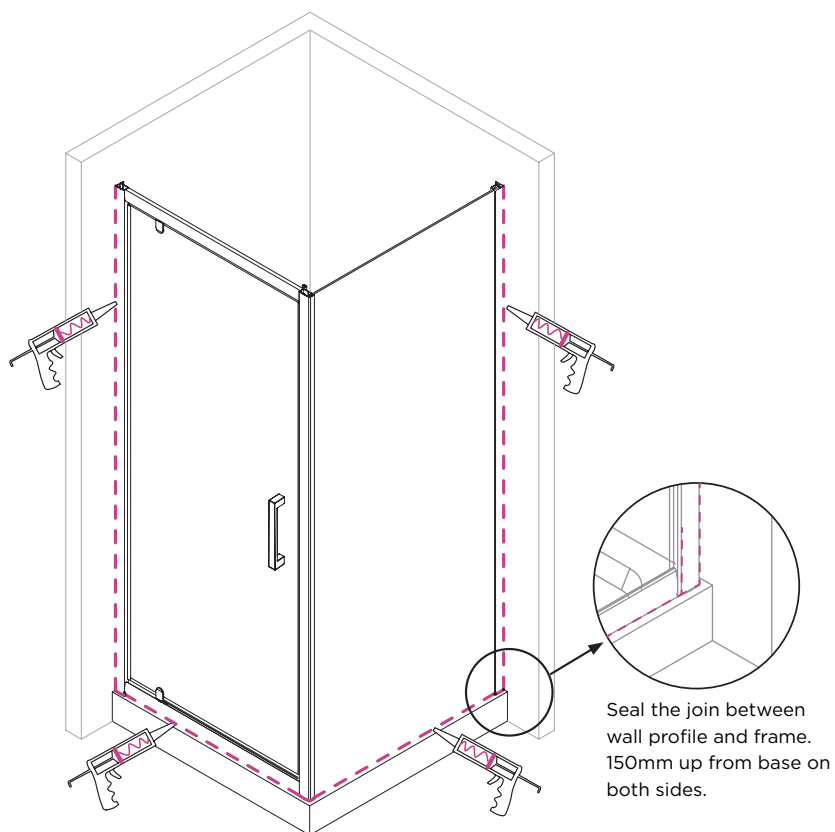

5



**Allow 24 hours for silicone to dry before use.**

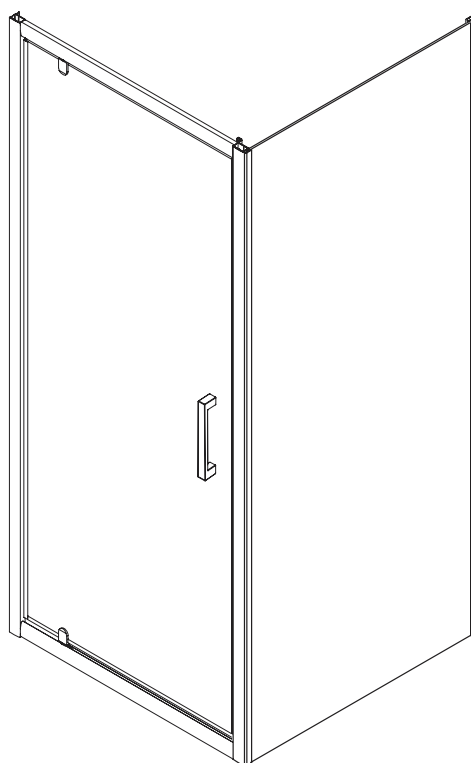

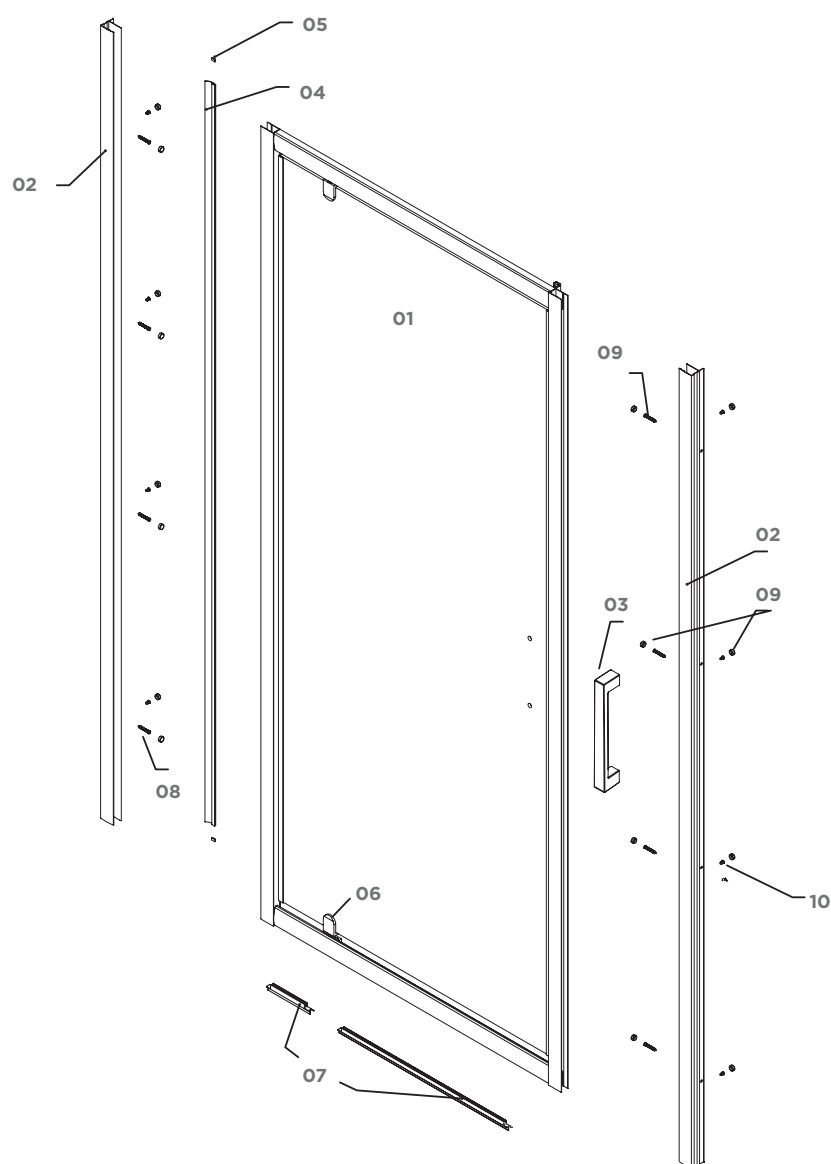

## COMPONENTS LIST

REFERENCE	DESCRIPTION	PART NUMBER	QUANTITY
1	Door Panel		1
2	Wall Channel	K7119	2
3	Handle	H1263*	1
4	Back Door Seal	K7072	2
5	Back Door Seal Stop	K4000	2
6	Pivot Block	K2004	1
7	Under Door Seal	K6068	2
8	Screw - 8x6 gauge x 38mm	Screw Pack F4163	1
9	Screw Caps		
10	Screws - 8x6 gauge 8-12 long		

\*Add .CR for Chrome code and .BK for Black

## WALL CHANNEL ADJUSTMENT: PIVOT 3-SIDED ALCOVE SHOWER TABLE

NORMAL TRAY SIZE	TRAY ACTUAL WIDTH (+/- 1MM)	LINER TO LINER MEASUREMENT	SCREEN MIN-MAX	EXTENSION AT WALL 2-SIDED OF FRAME
900mm	900mm	874mm	860mm - 890mm	7mm
1000mm	1000mm	974mm	960mm - 990mm	7mm
1200mm	1200mm	1174mm	1155mm - 1185mm	9.5mm

**NOTE:** Make sure the correct shower is used on the correct tray.

- 1** Walls out of plumb will not allow for full minimum / maximum options.

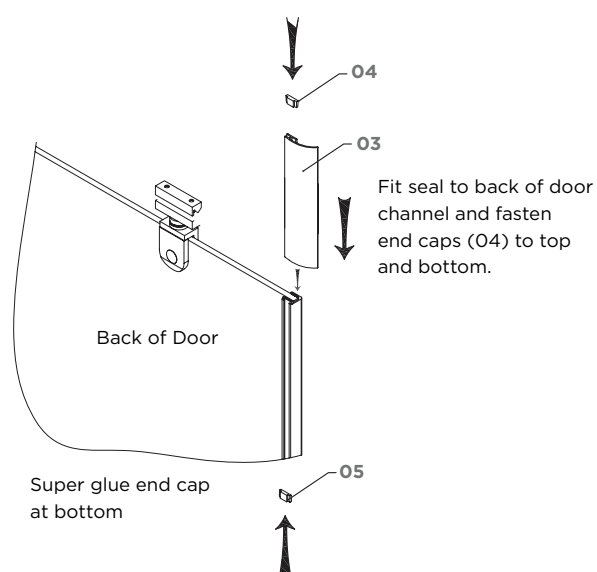

## 2 1200 DOOR-SET INCLUDES A FIXED GLASS PANEL

Drawing on page 3 of Components List

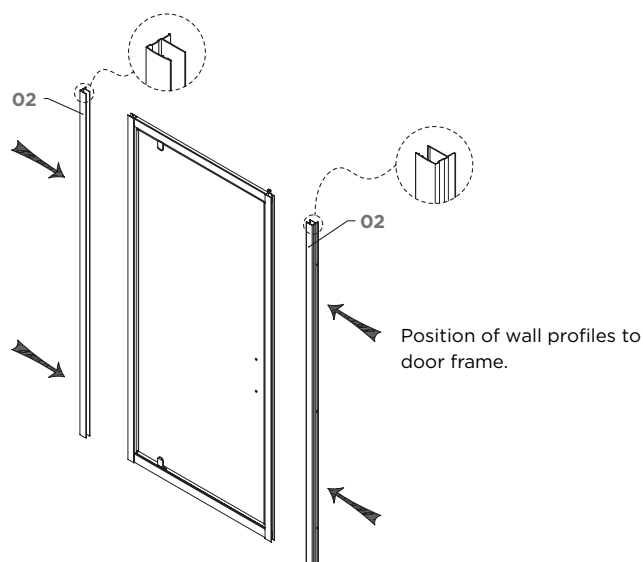

3

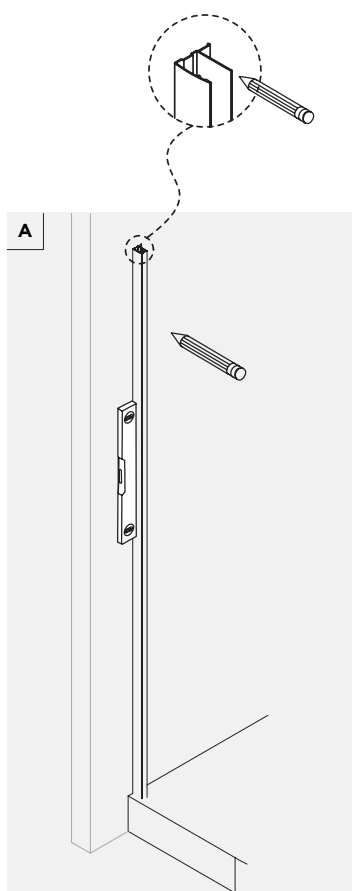

Mark wall profile holes both sides.  
Predrill liner with 2mm bit.

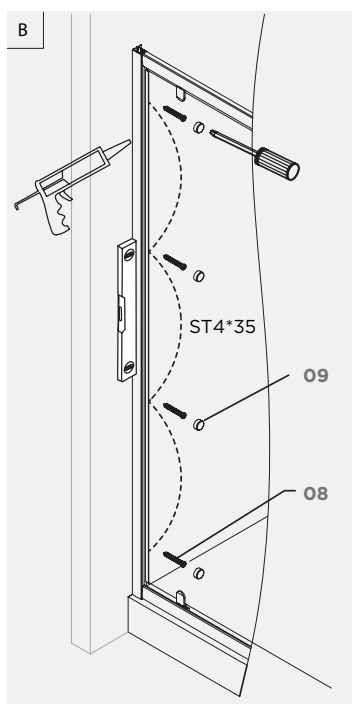

Fasten wall profiles.

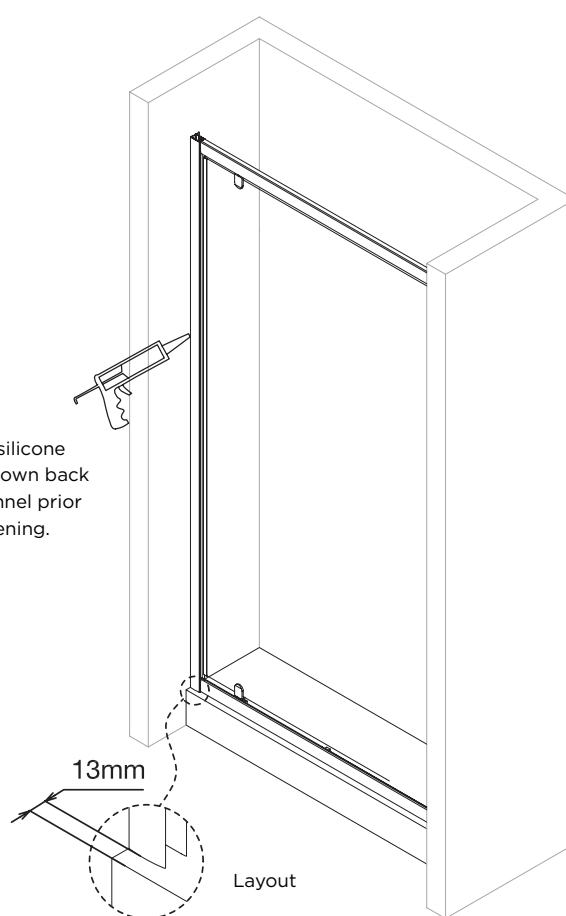

Apply silicone  
bead down back  
of channel prior  
to fastening.

4

1. Plumb and square up door to frame.
2. Adjust evenly to both wall profiles.

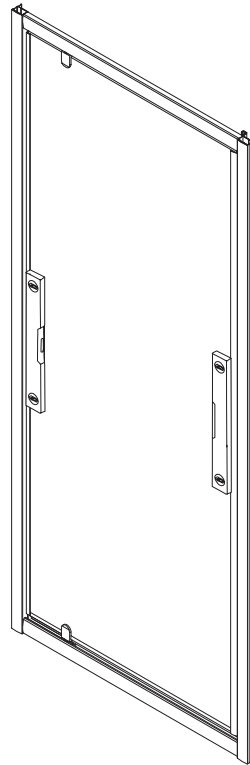

5

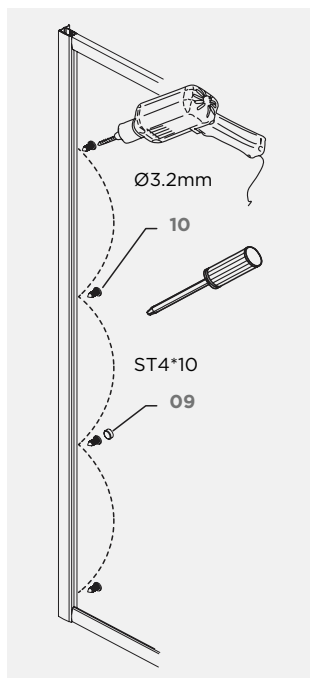

Fasten door frame to wall profiles.

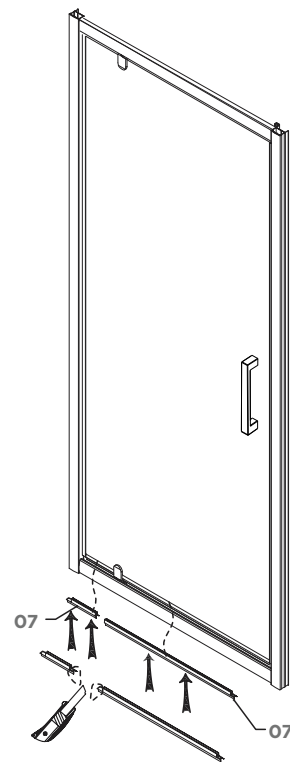

Door seal full width of door. Notch out glass flange by 12mm each end of door. Trim each side of pivot.

6

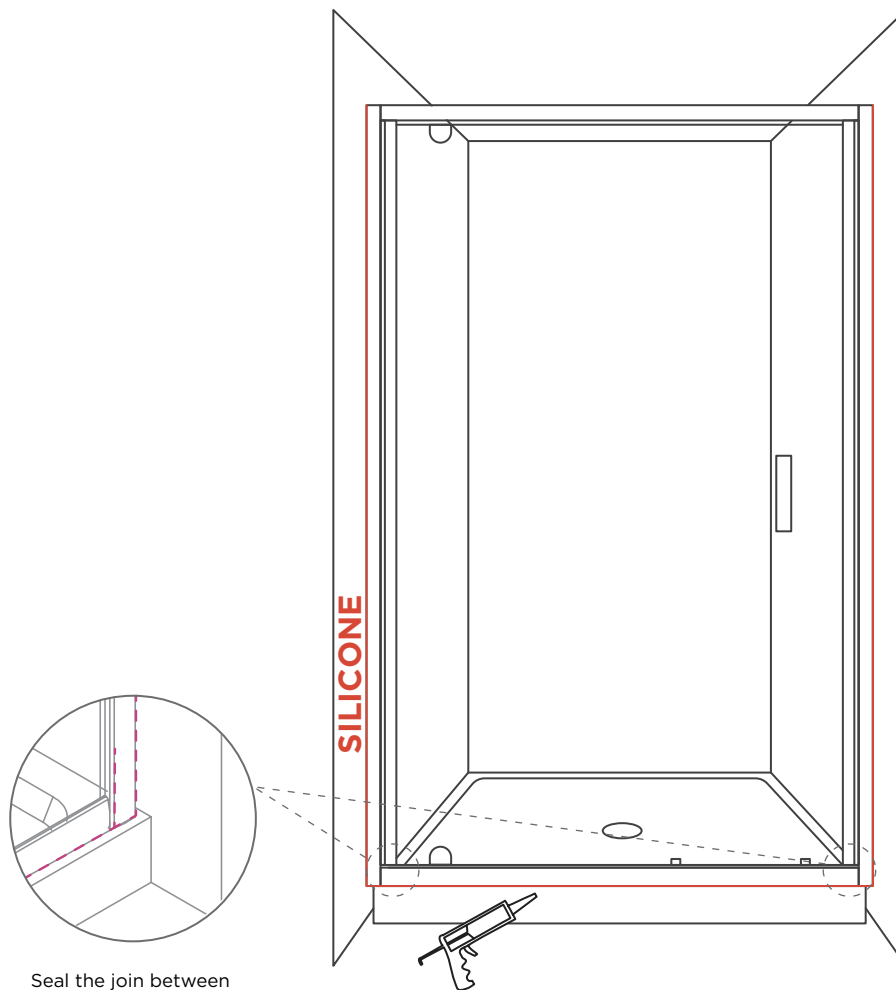

Seal the join between wall profile and frame 150mm up from base on both sides.



**Allow 24 hours for silicone to dry before use.**