

Important

1. When you receive your product check the contents for any freight damage or defects.
2. If this is a custom order, the size will be on the outside of the box. Check that it is correct.
3. Advise Marni on 0800 4 MARNI if any damage has occurred or if you have any questions about the size within 8 hours of receiving the goods so this can be rectified.
4. Do not install faulty products, as this will void your warranty.



Health and Safety

- Unpack glass, stand on soft packing on floor and walls prior to assembly.
- Do not rework glass panels.
- Do not strike an edge or corner of glass.
- Use two persons where heavy glass lifting is required.
- Wear appropriate protective clothing and eye protection during installation.
- Mark gas/water pipe and electrical wire locations to ensure these are not touched.



Attention

- **The tray base** must be installed level as this affects all shower alignments.
- **Wall Specifications** require a max variation of 3mm within shower height.
Installer must check the viability of install if outside of these specs.
- **3-Sided Alcove Showers:** Wall must be accurate, straight, and plumb. Refer pre-install guide.
- **Double studs for solid fixing of wall channels:** Positioned at tray outside edge



Tools Required



Warranty

- This covers faulty goods but not breakages. Visit marni.nz for information.
- Compliance with Specs and these instructions are essential for a valid warranty.

We recommend a skilled tradesman acquainted with shower installations to ensure the very best outcome.

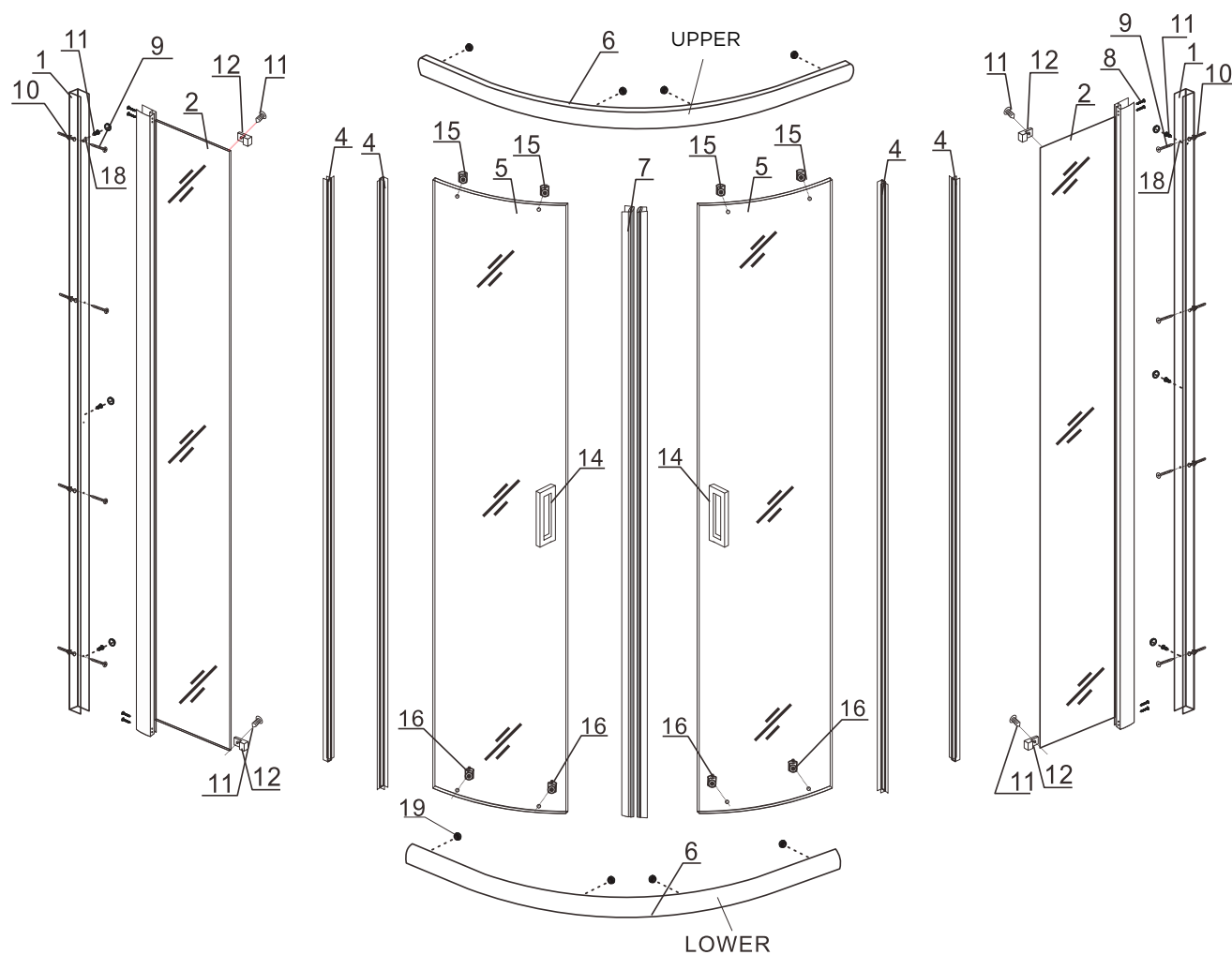

COMPONENTS LIST

| REFERENCE | DESCRIPTION | QUANTITY |
|-----------|--------------------------------------|----------|
| 1 | Wall Channel | 2 |
| 2 | Fixed Glass Panel | 2 |
| 4 | Deflector Seal | 4 |
| 5 | Door Glass | 2 |
| 6 | Curved Rail Profile | 2 |
| 7 | Magnetic Sealer | 1 |
| 8 | Fixed Glass to Curved Rail Screw | 8 |
| 9 | Wall Channel Screw | 8 |
| 10 | Wall Plug (Concrete) | 8 |
| 11 | Frame to Wall Channel & Glass Clamps | 10 |
| 12 | Glass Clamps | 4 |
| 14 | Handle | 2 |
| 15 | Top Roller | 4 |
| 16 | Bottom Roller | 4 |
| 18 | Screw Cover | 6 |
| 19 | Bump Stop Cap | 8 |

| SHOWER TYPE | WALL CHANNEL ADJUSTMENT |
|-----------------|-------------------------|
| 900mm x 900mm | 870mm to 890mm |
| 1000mm x 1000mm | 970mm to 990mm |

NOTE: Make sure the correct shower is used on the correct tray.

Walls out of plumb will not allow for full minimum / maximum options.

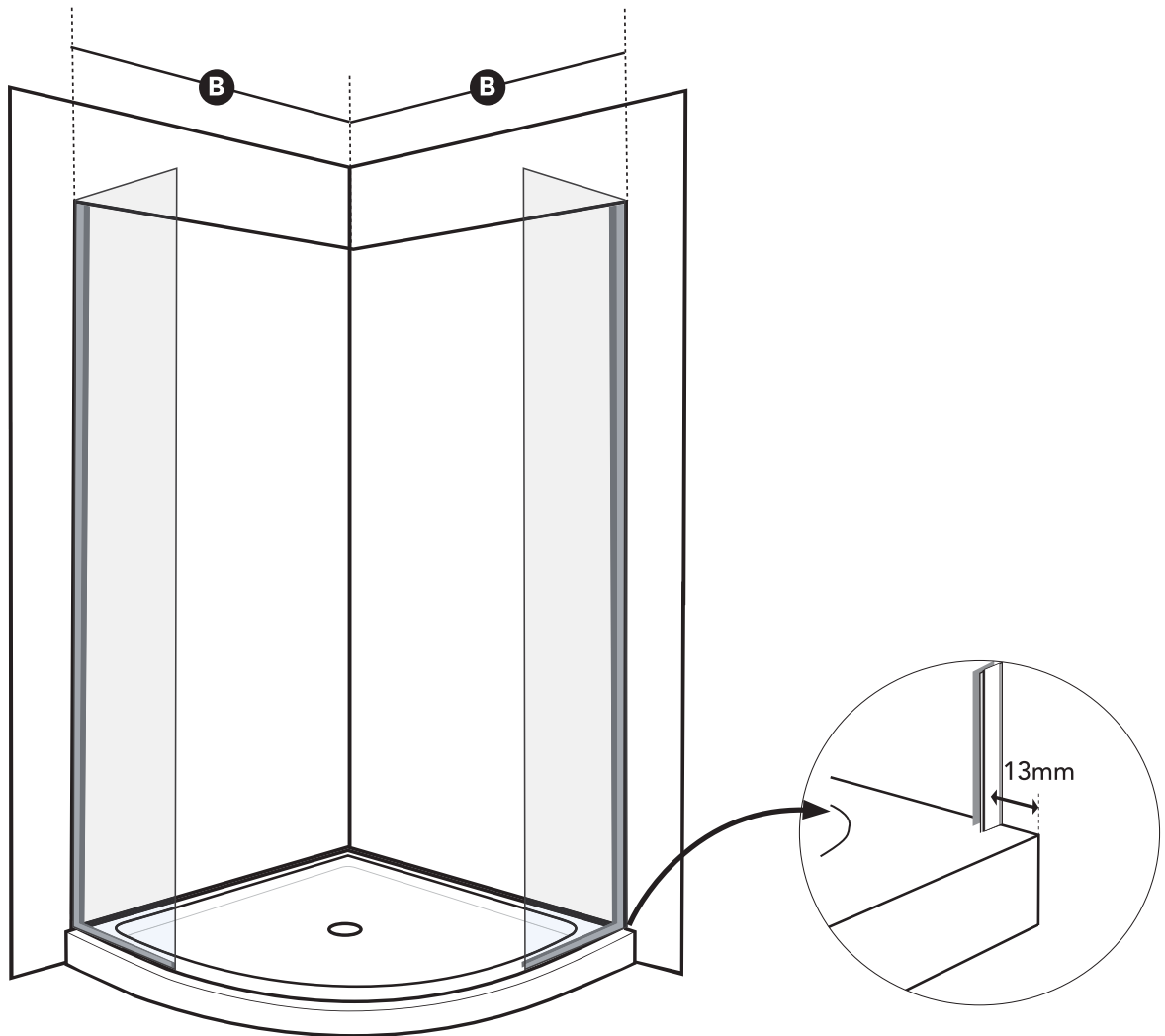

- Mark out the wall channels 13mm off acrylic tray edge.
- If the tray is not level or walls are out of plumb protruding or curving inwards more than 4mm recalculation of this position as required. Use the Min to Max Table above.
- Plumb and mark the boundary lines of wall channels and predrill a 2mm lead hole in the liner.
- Apply a continuous 7mm bead of silicone on the back of channel, fasten to wall ensuring these remain plumb.

1 Make up shower frame. Attach at the four corners.

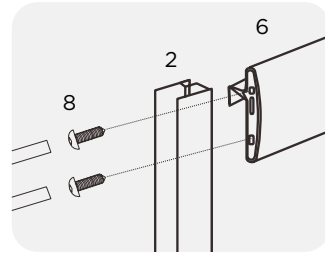
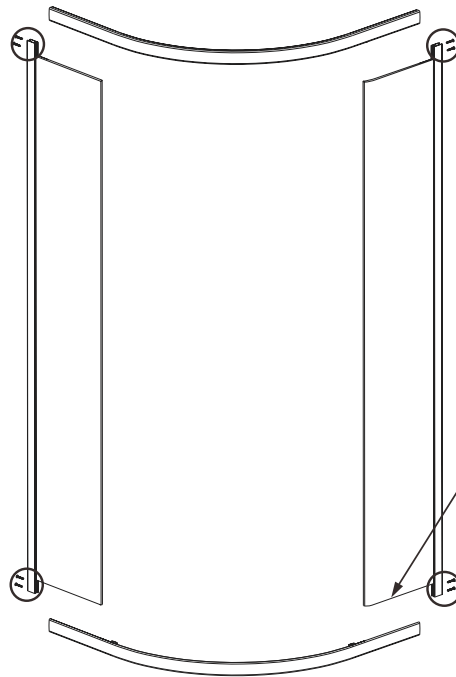

With Bottom Rail still loose, apply silicone between rail and fixed glass. Clean off excess when frame is tight, and Glass Clamp fitted.

2 Install glass clamps.

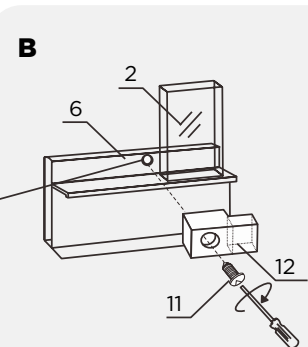
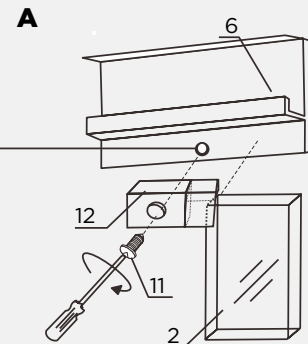
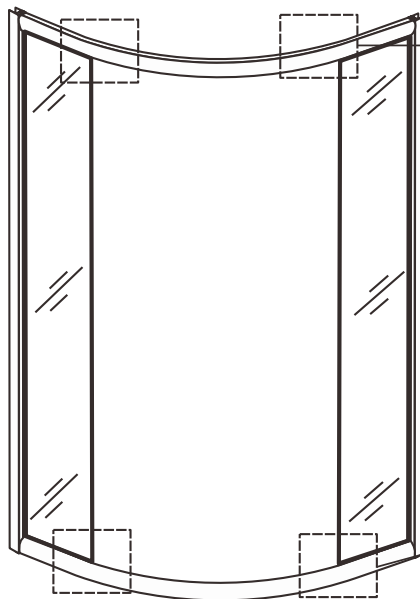

3 Install seals (4) to fixed glass.

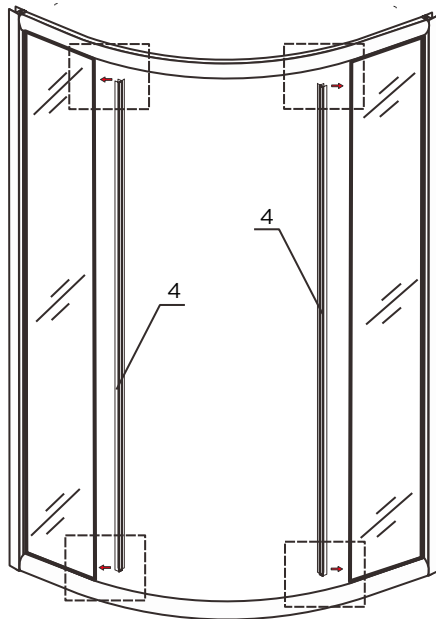

Ensure all steps 5, 6 & 7 are complete prior to step 8.

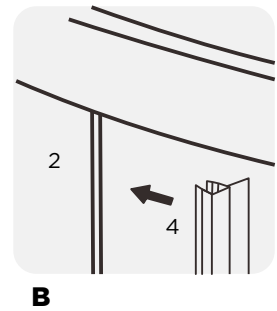
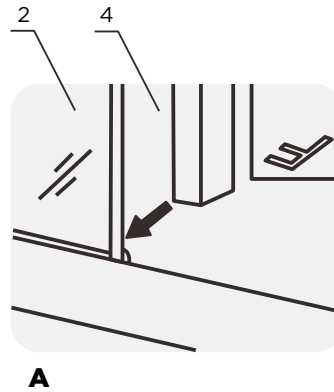

4 Enter frame into wall channels.

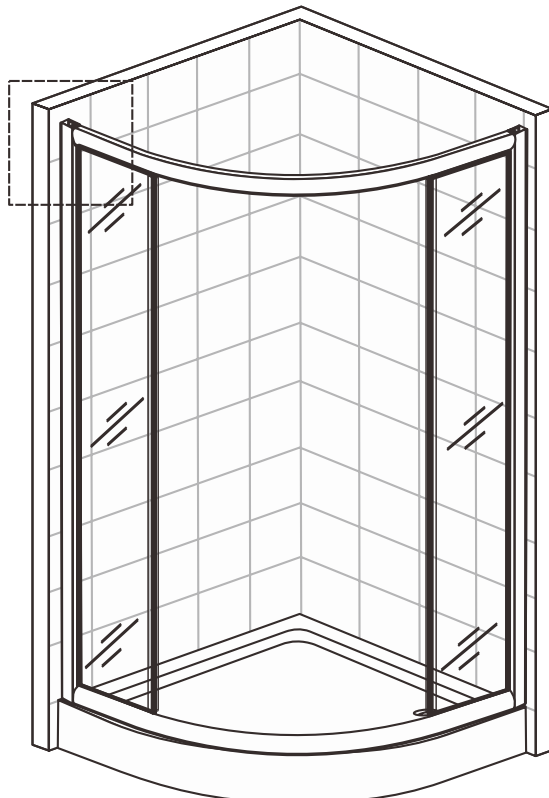

A

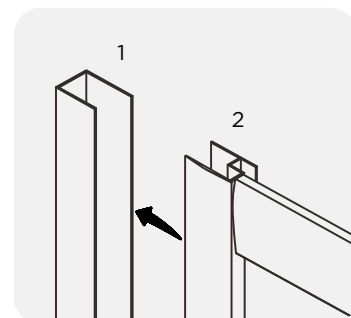

5 Align frame to wall channels and tray edge.

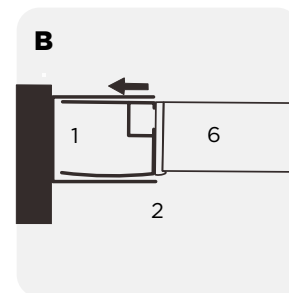
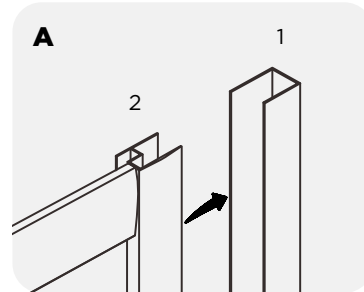
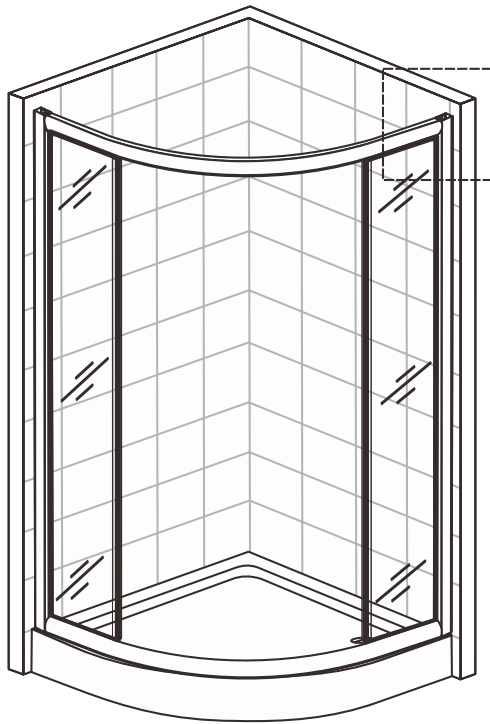

6 Check levels and plumb.

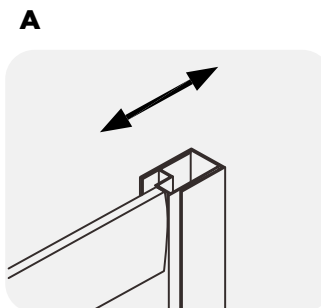
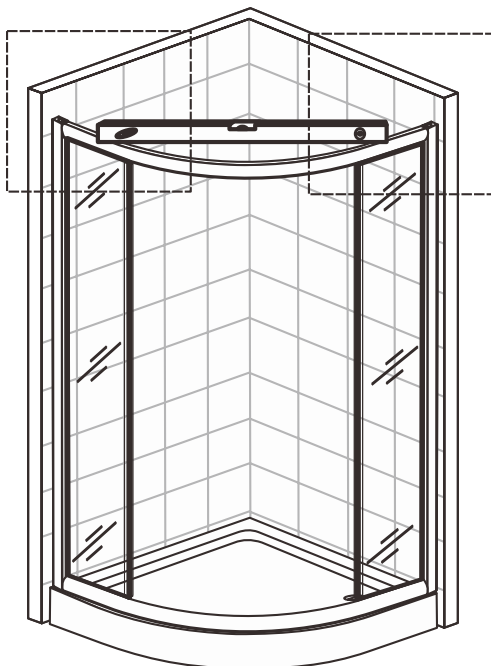

7 Fasten frame to wall channels.

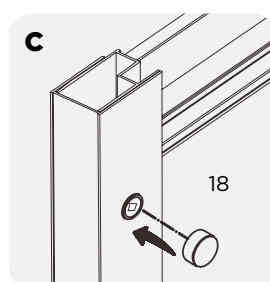
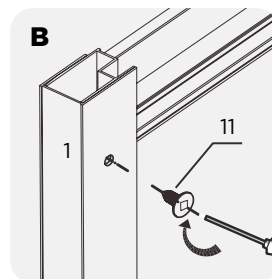
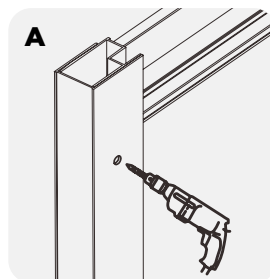
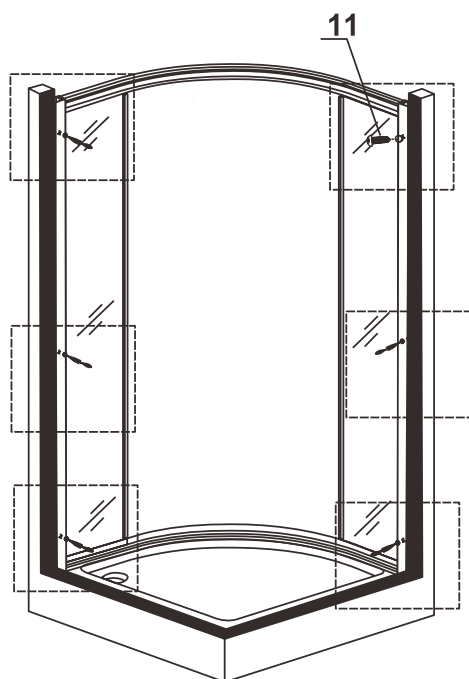

8 Assemble door rollers.

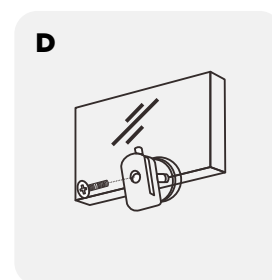
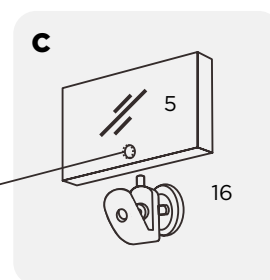
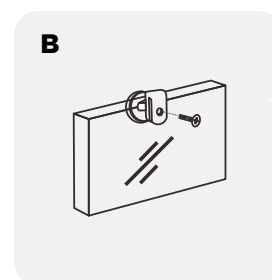
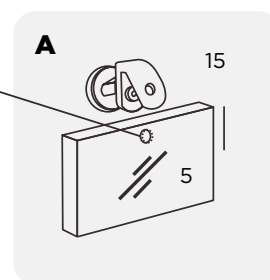
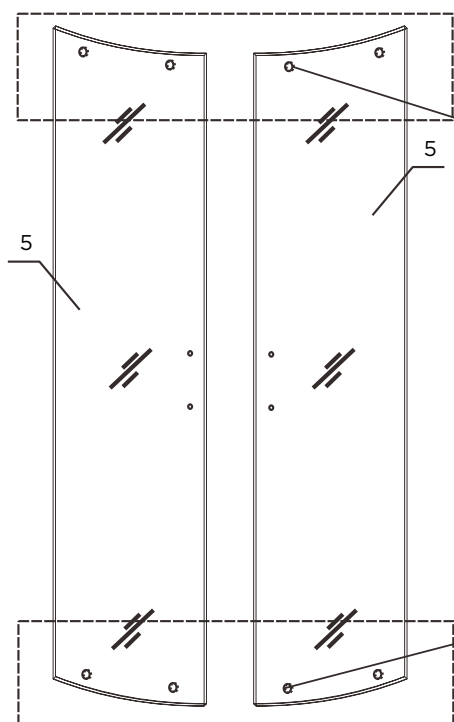

9 Fit back door seals.

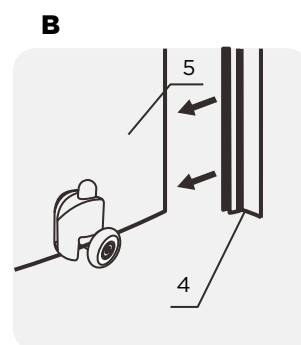
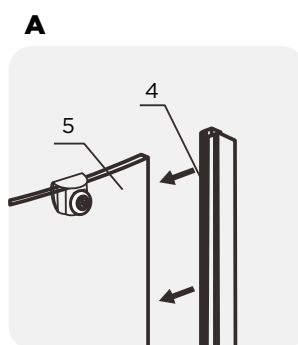
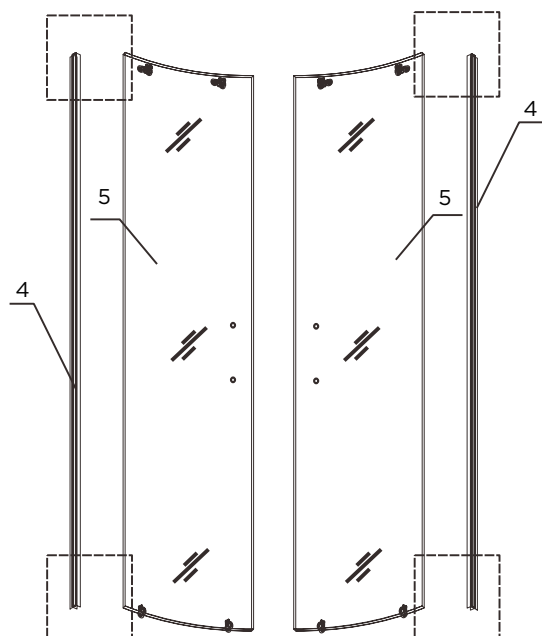

10 Fit magnetic seals and handle.

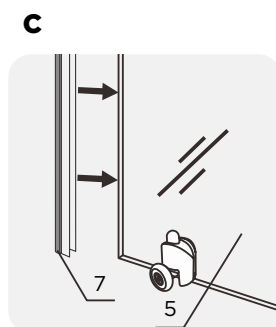
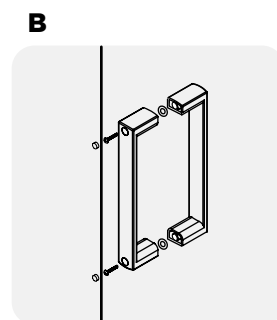
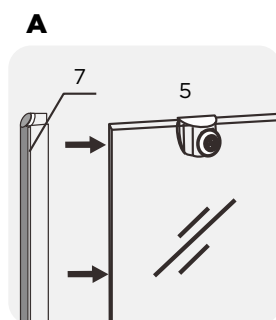
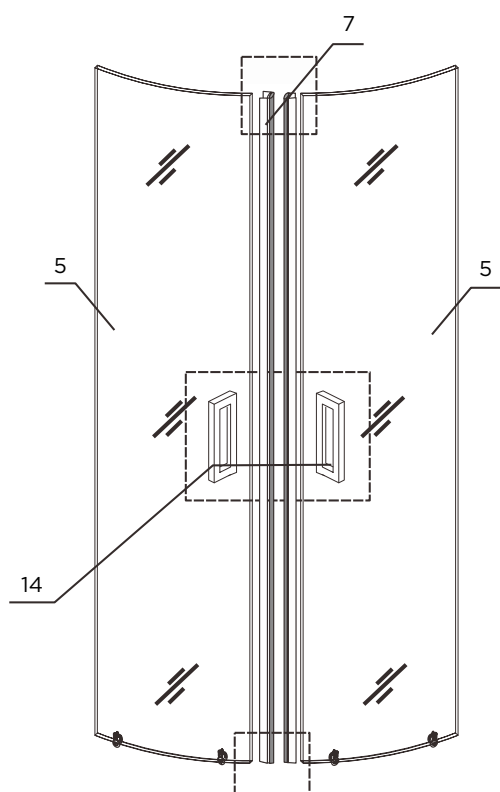

11 Install doors into frame.

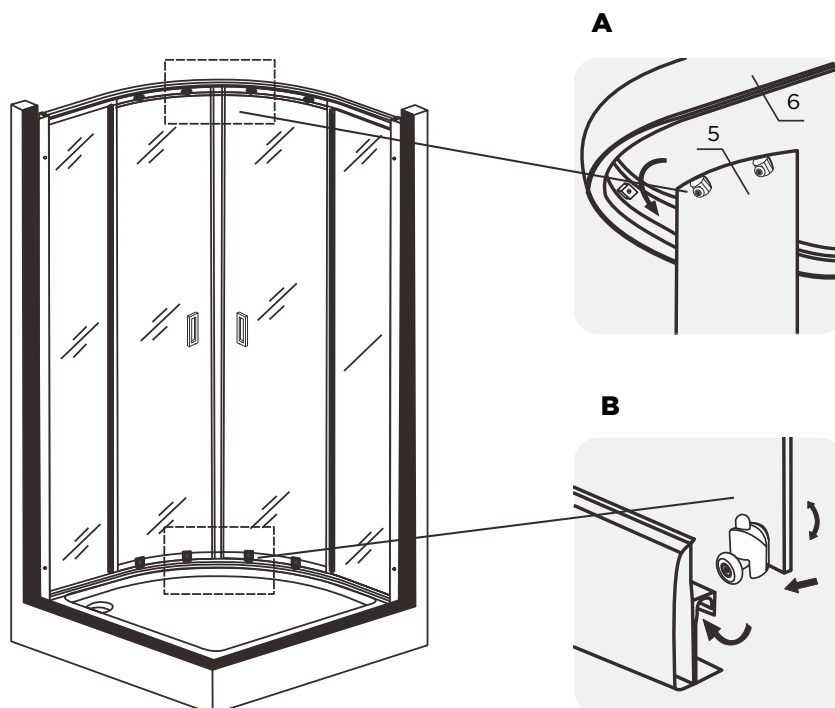

12 Fit bump stop caps.

Adjust top rollers to take up slack and align parallel to close. Do not overtighten.

A

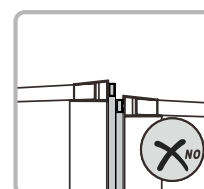
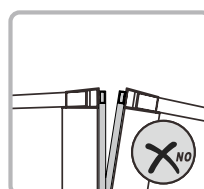
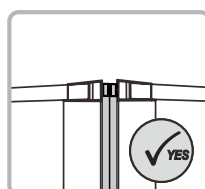
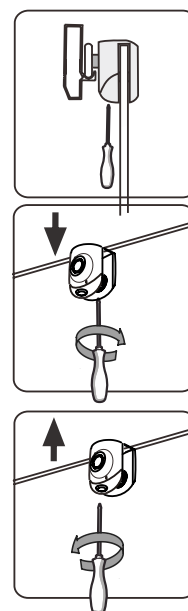
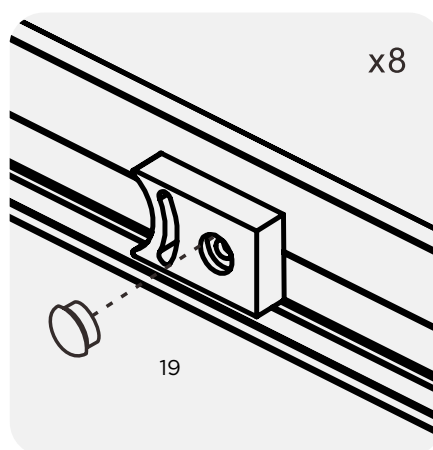

13

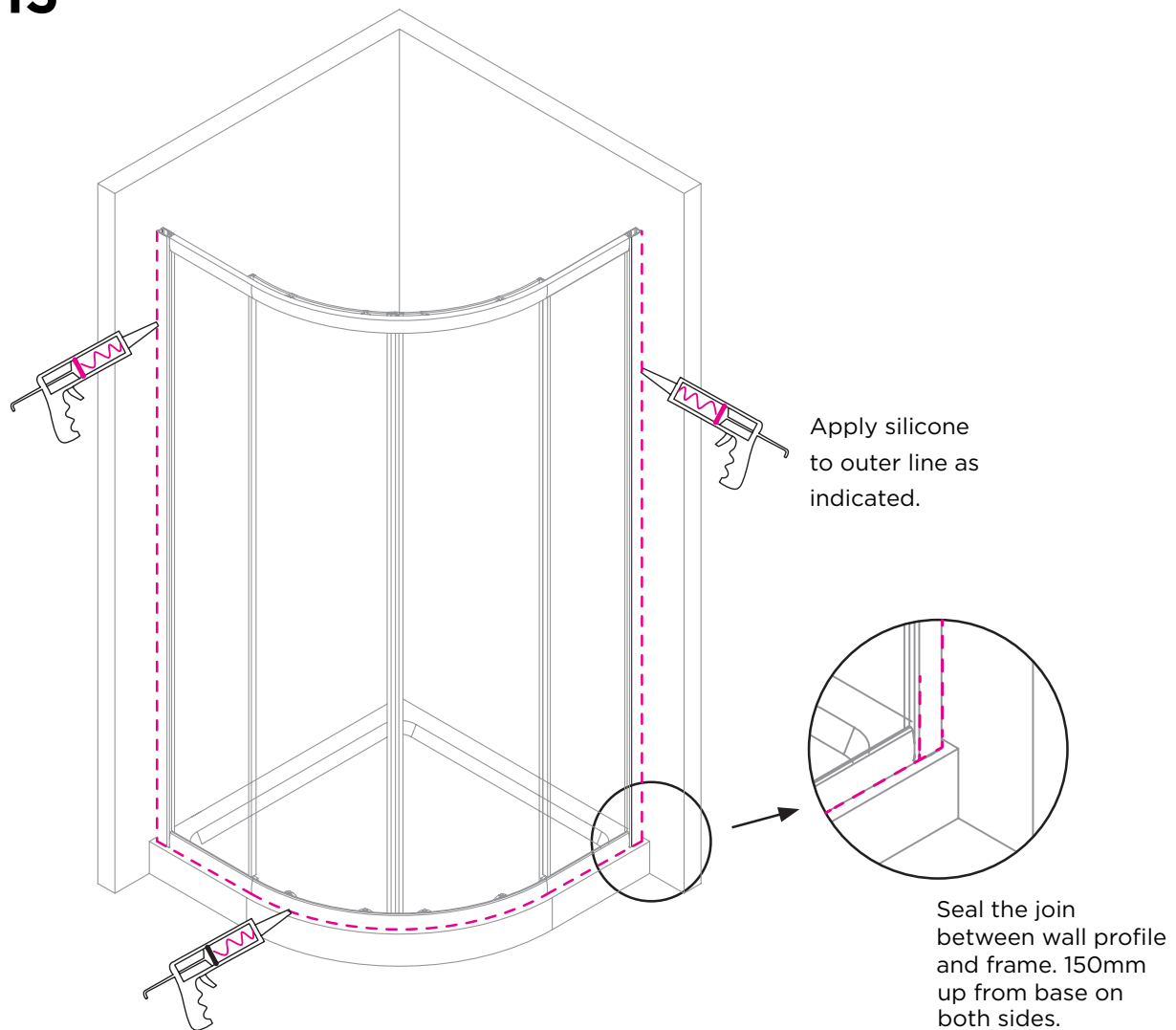

Allow 24 hours for silicone to dry before use.