

Important

1. When you receive your product check the contents for any freight damage or defects.
2. If this is a custom order, the size will be on the outside of the box. Check that it is correct.
3. Advise Marni on 0800 4 MARNI if any damage has occurred or if you have any questions about the size within 8 hours of receiving the goods so this can be rectified.
4. Do not install faulty products, as this will void your warranty.



Health and Safety

- Unpack glass, stand on soft packing on floor and walls prior to assembly.
- Do not rework glass panels.
- Do not strike an edge or corner of glass.
- Use two persons where heavy glass lifting is required.
- Wear appropriate protective clothing and eye protection during installation.
- Mark gas/water pipe and electrical wire locations to ensure these are not touched.



Attention

- **The tray base** must be installed level as this affects all shower alignments.
- **Wall Specifications** require a max variation of 3mm within shower height.
Installer must check the viability of install if outside of these specs.
- **3-Sided Alcove Showers:** Wall must be accurate, straight, and plumb. Refer pre-install guide.
- **Double studs for solid fixing of wall channels:** Positioned at tray outside edge



Tools Required

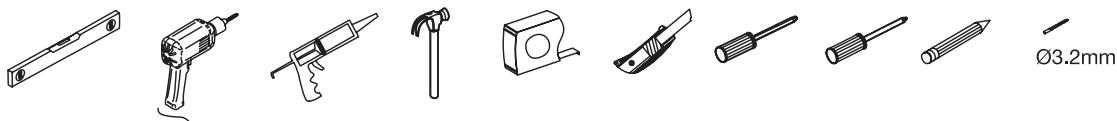

Warranty

- This covers faulty goods but not breakages. Visit marni.nz for information.
- Compliance with Specs and these instructions are essential for a valid warranty.

We recommend a skilled tradesman acquainted with shower installations to ensure the very best outcome.

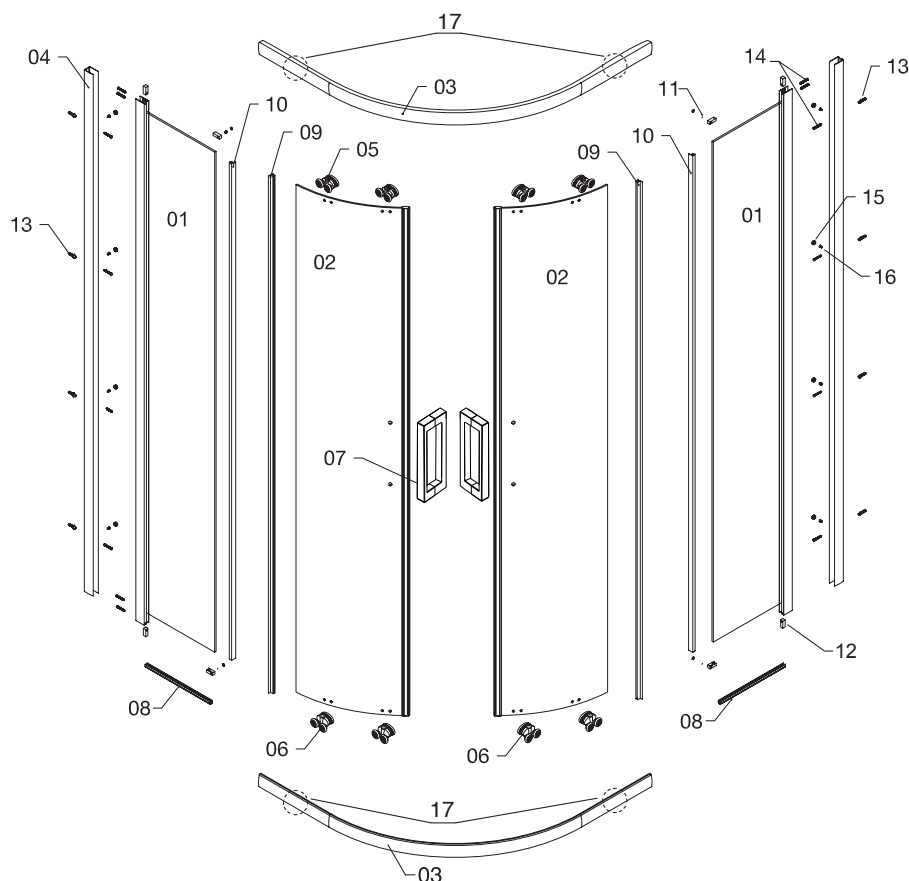

COMPONENTS LIST

REFERENCE	DESCRIPTION	PART NUMBER	QUANTITY
1	Fixed Glass Panels		2
2	Door Glass		2
3	Curved Rails		2
4	Wall Profile Chrome	K7126	2
	Wall Profile White	K7113	2
	Wall Profile Black		2
5	Top Roller	K7027	4
6	Bottom Roller	K6792	4
7	Handle	H1263.CR	2
		H1263.BK	2
8	Fixed Glass Bottom Seal	K8617	2
9	Back Door Seal	K2264	2
10	Fixed Panel Seal	K7034	4
11	Glass Clamp + Flat Tip Screw	Screw Pack K2288*	4
12	Space Block		8
13	Wall Plug (Concrete)		16
14	Screw ST4*35		8
15	Screw ST4*10		8
16	Cap		8
17	Curved Rail Stops		

*Code for Replacement Screw Pack - 2 & 3 Sided Chrome & White

SHOWER TYPE	WALL CHANNEL ADJUSTMENT	TRAY TYPE
900mm*900mm	868mm (Minimum) to 888mm (Maximum)	Standard Profile Tray
1000mm*1000mm	968mm (Minimum) to 988mm (Maximum)	Standard Profile Tray

NOTE: Make sure the correct shower is used on the correct tray.

1

Walls out of plumb will not allow for full minimum / maximum options.

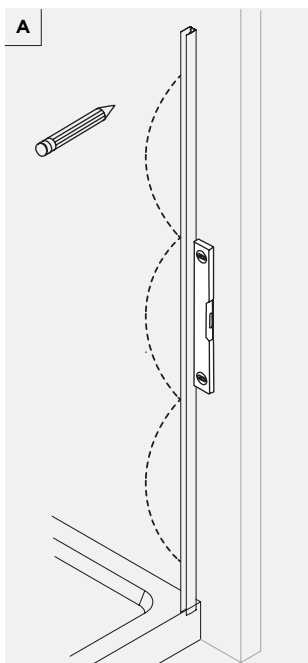
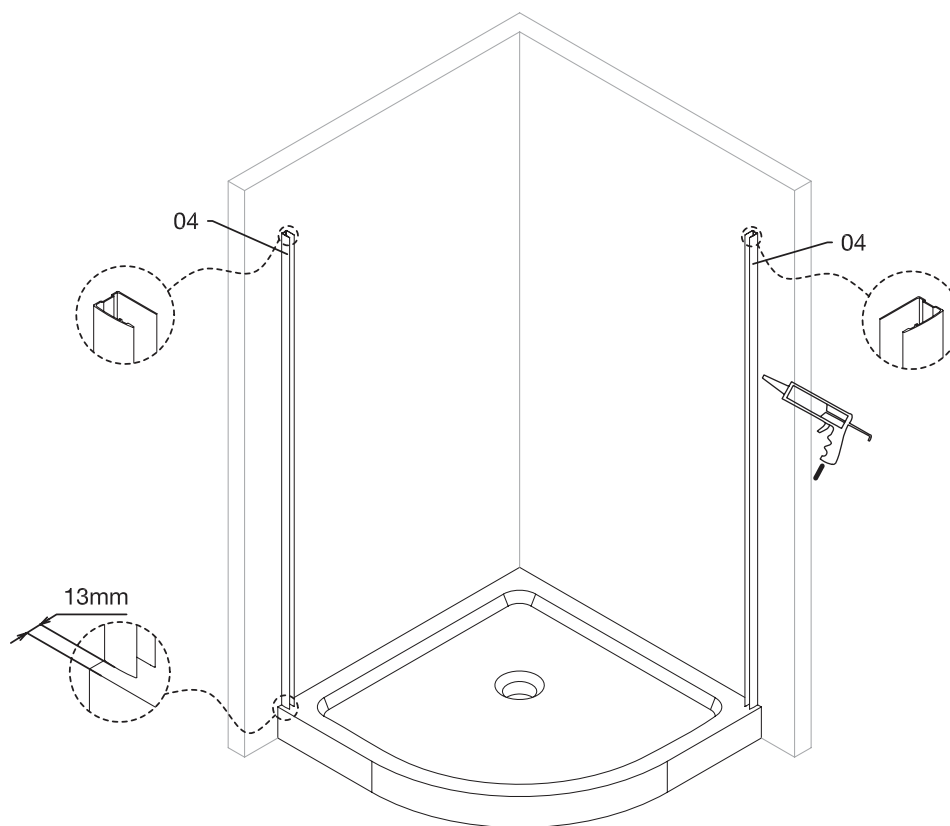

Mark Wall Profile

Acrylic Shower Layout

Position the wall channels at 13mm off the tray edge as diagram above. This allows for walls bowed or leaning inwards up to 6mm. Reduce the measurement off the tray edge if walls dictate this. **Refer to table above.**

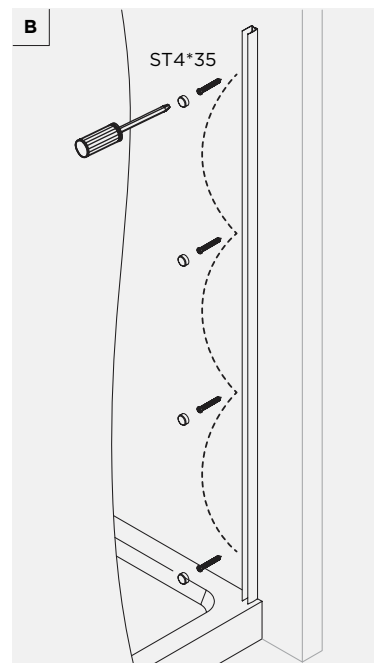

Fasten wall profiles for return and door panels.

2 ASSEMBLY OF FRAME AND FIXED GLASS



IMPORTANT! Complete all items in this section before Step 3

A

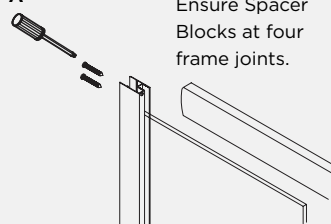

B

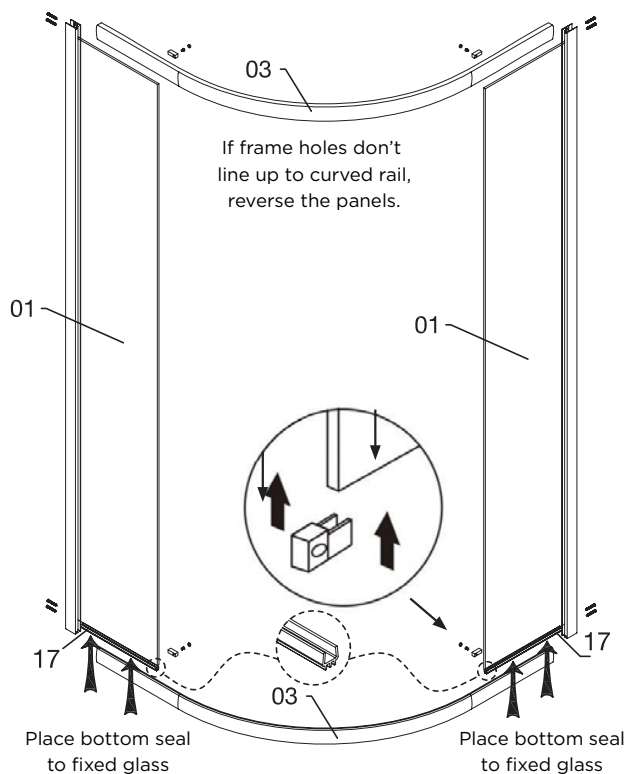
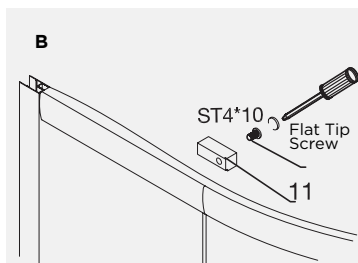

3

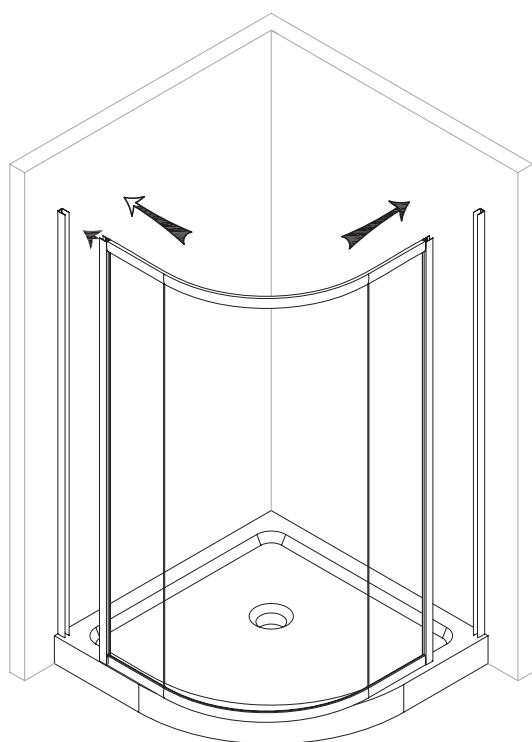

Install frame to wall profiles.

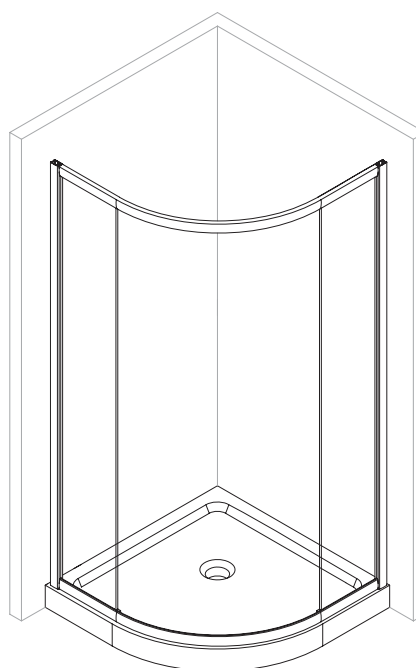

Adjust/align frame to tray edge.

4 DOOR COMPONENT DETAILS

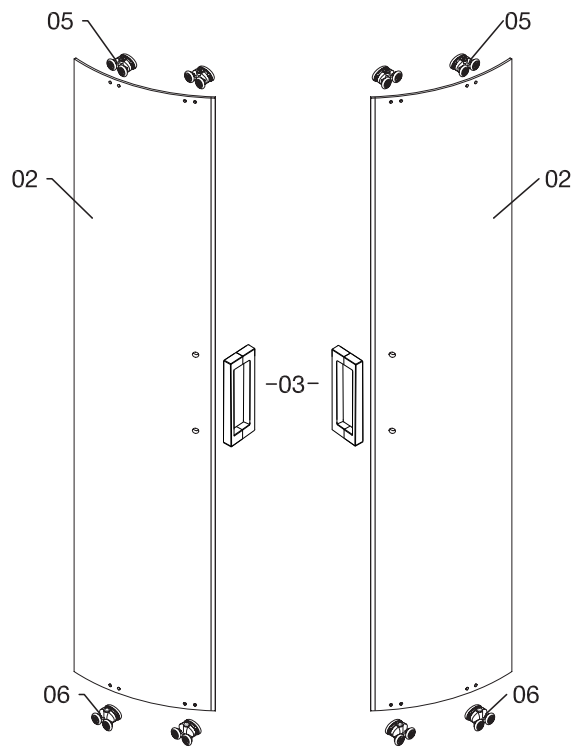
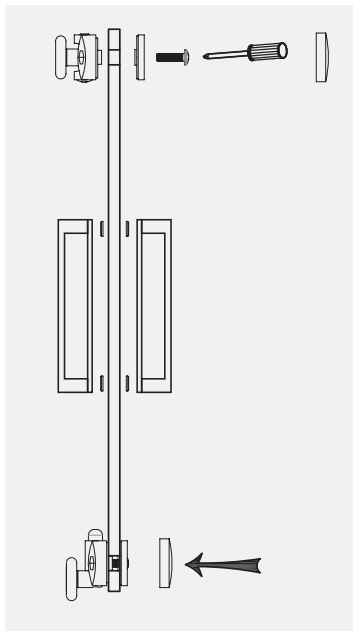

DOOR PARTS

5 DOOR INSTALL

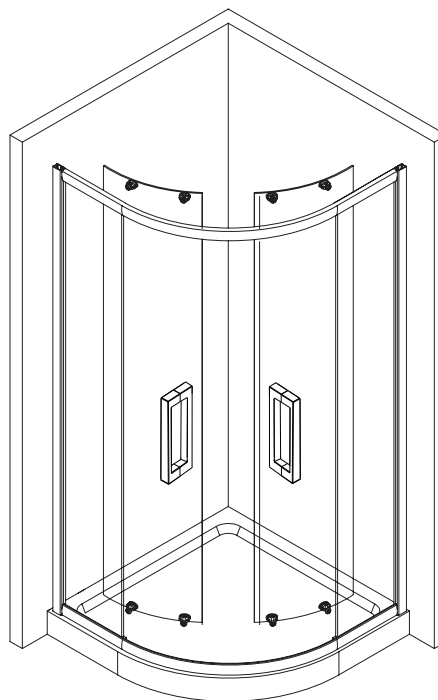
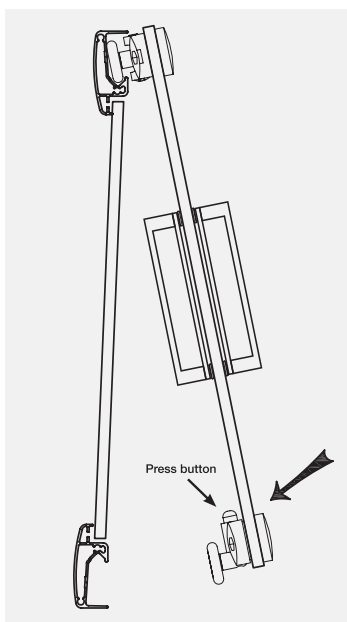

6 SEAT INSTALL

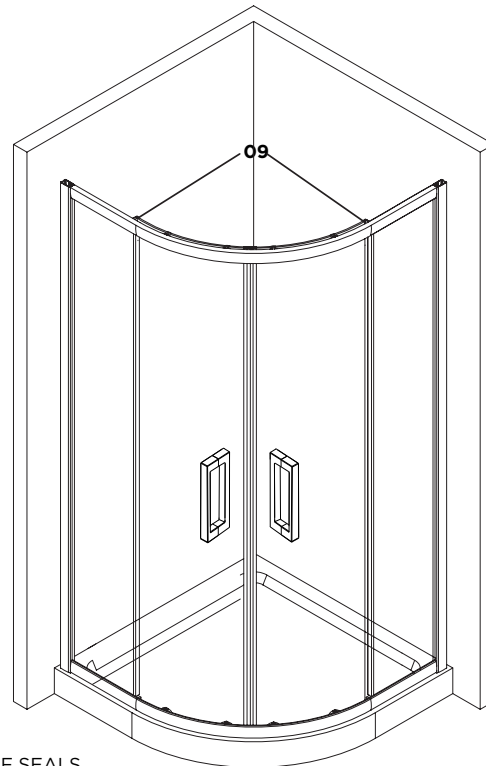
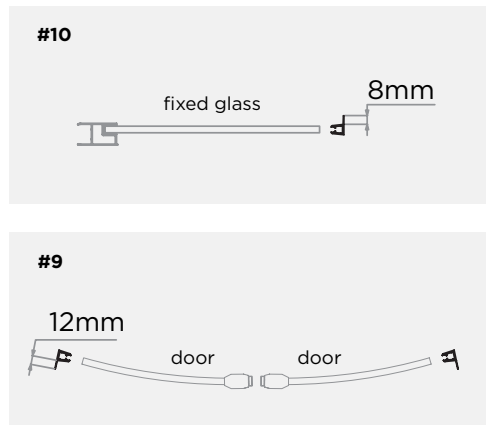

FITTING OF SEALS

7 ALIGN FRAME, PLUMB AND SECURE TO WALL CHANNEL

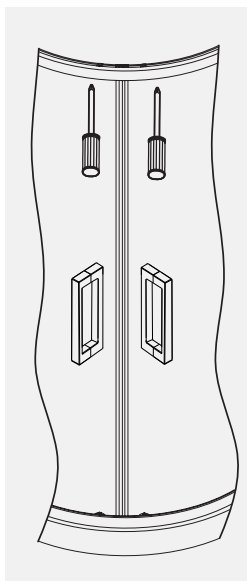

Adjust rollers but do not over tighten.

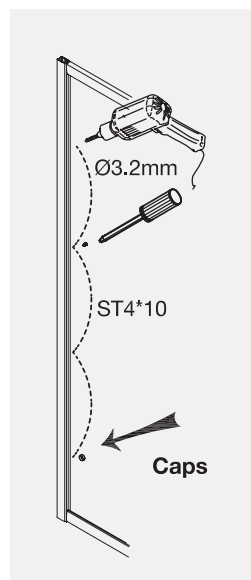

Align shower within wall profiles. Fasten frame to wall profiles.

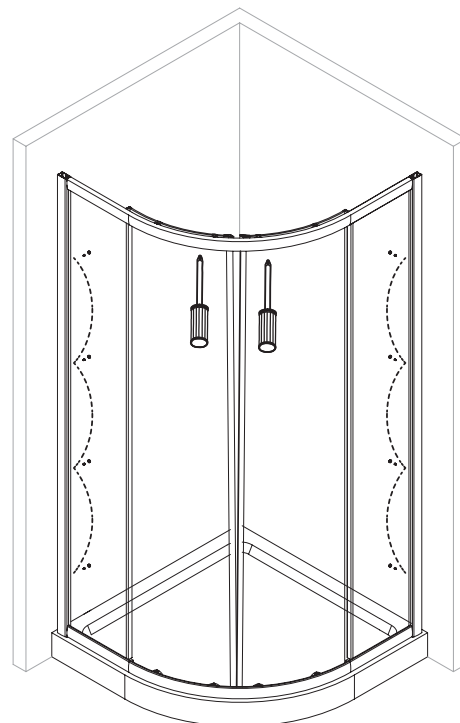

Finally adjust doors to align. Put bump stop covers on.

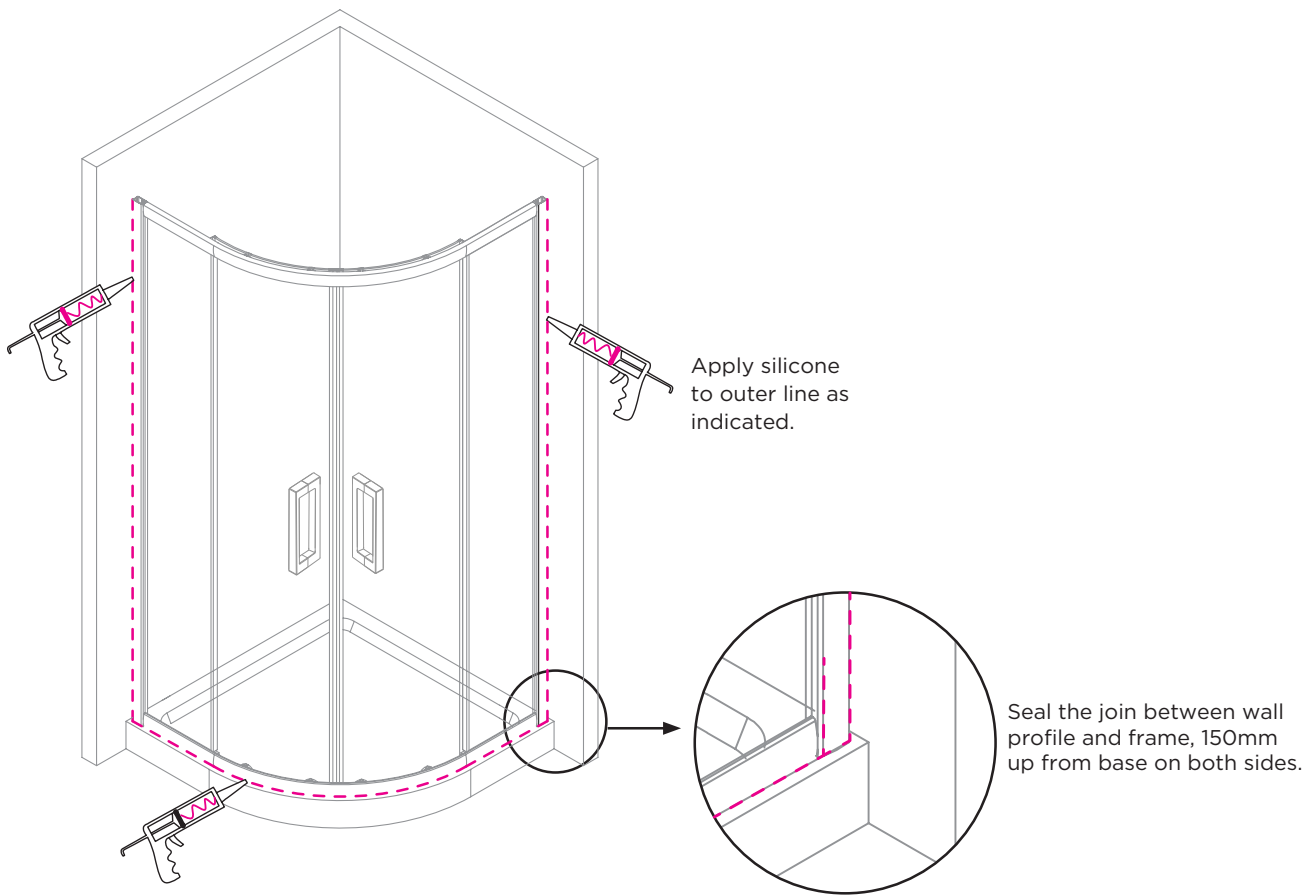

Allow 24 hours for silicone to dry before use.