

# Urban Corner Angle Shower

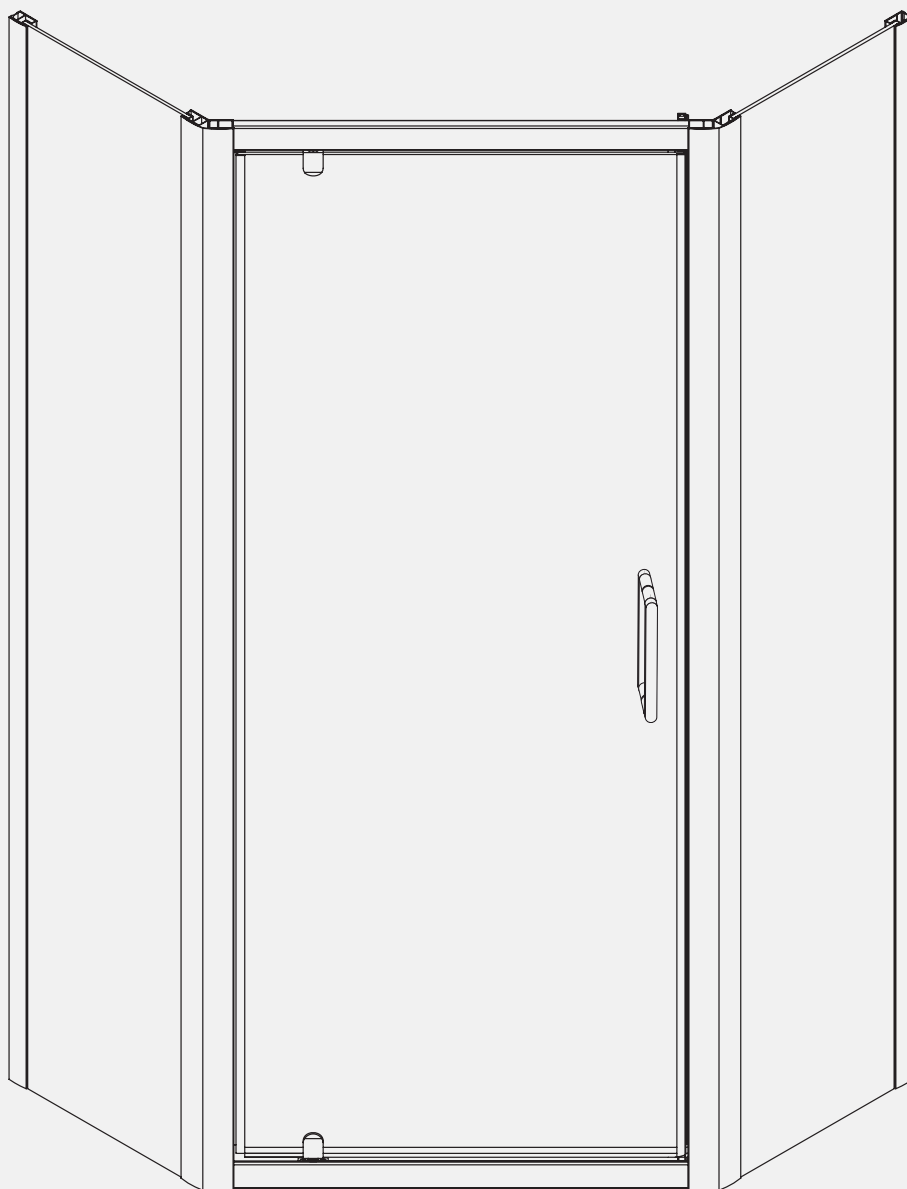

## Important

1. When you receive your product check the contents for any freight damage or defects.
2. If this is a custom order, the size will be on the outside of the box. Check that it is correct.
3. Advise Marni on 0800 4 MARNI if any damage has occurred or if you have any questions about the size within 8 hours of receiving the goods so this can be rectified.
4. Do not install faulty products, as this will void your warranty.



## Health and Safety

- Unpack glass, stand on soft packing on floor and walls prior to assembly.
- Do not rework glass panels.
- Do not strike an edge or corner of glass.
- Use two persons where heavy glass lifting is required.
- Wear appropriate protective clothing and eye protection during installation.
- Mark gas/water pipe and electrical wire locations to ensure these are not touched.



## Attention

- **The tray base** must be installed level as this affects all shower alignments.
- **Wall Specifications** require a max variation of 3mm within shower height.  
Installer must check the viability of install if outside of these specs.
- **3-Sided Alcove Showers:** Wall must be accurate, straight, and plumb. Refer pre-install guide.
- **Double studs for solid fixing of wall channels:** Positioned at tray outside edge



## Tools Required

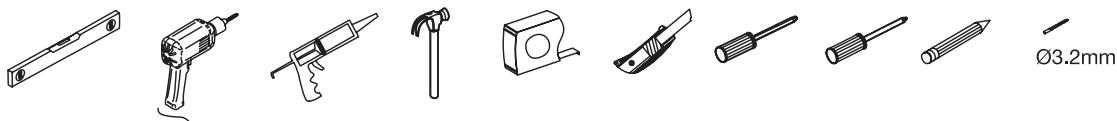

## Warranty

- This covers faulty goods but not breakages. Visit [marni.nz](http://marni.nz) for information.
- Compliance with Specs and these instructions are essential for a valid warranty.

**We recommend a skilled tradesman acquainted with shower installations to ensure the very best outcome.**

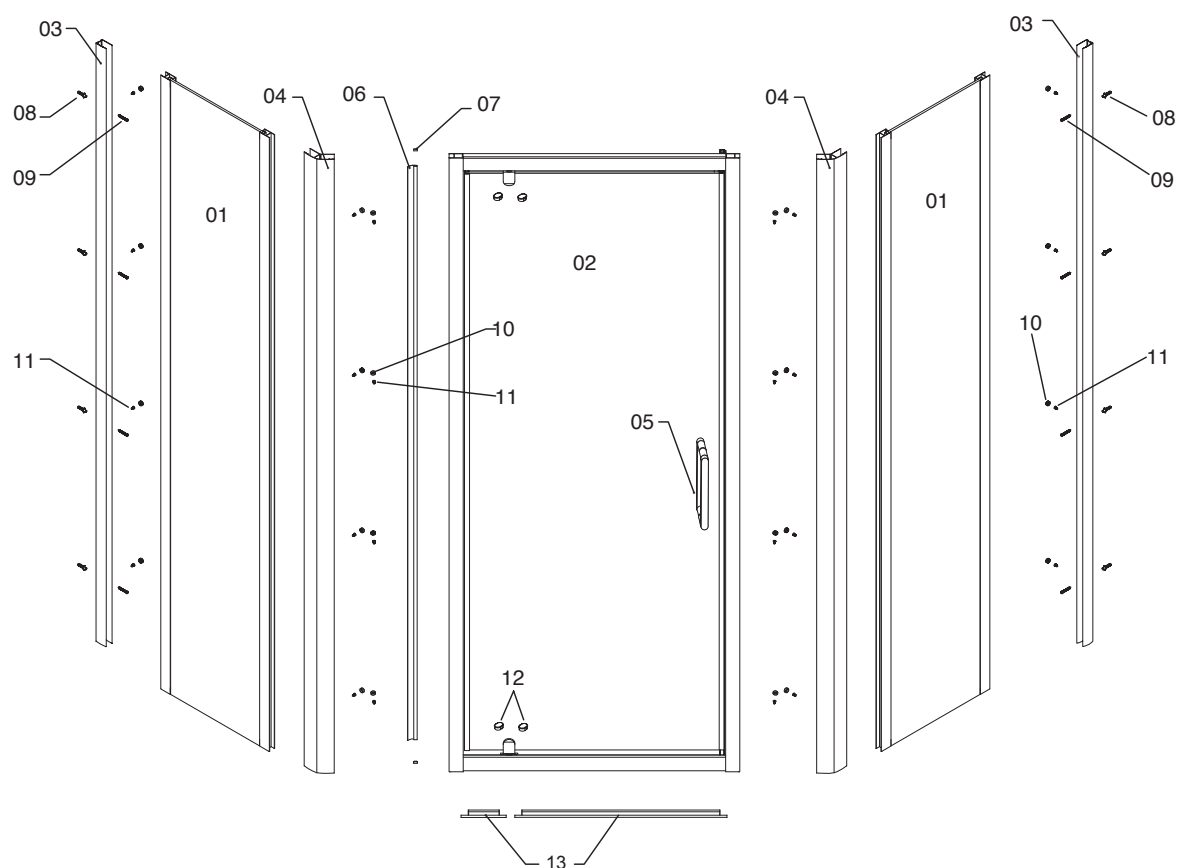

## COMPONENTS LIST

REFERENCE	DESCRIPTION	PART NUMBER	QUANTITY
1	Fixed Glass Panels		2
2	Door Glass		1
3	Wall Profile Chrome	K7109	2
	Wall Profile White	K7119	2
4	Corner Post		2
5	Handle	H1263.CR	1
6	Back Door Seal	K7072	1
7	Seal End Caps	K3829	2
8	Wall Plug (Concrete)	Screw Pack K2295*	8
9	ST4*35		8
10	ST4*8		24
11	Screw Cap		24
12	Pivot Mounting Cap		4
13	Bottom Door Seal	K6808	2

\*Code for Replacement Screw Pack - 2 & 3 Sided Chrome & White

SHOWER TYPE	WALL CHANNEL ADJUSTMENT	TRAY TYPE
900mm*900mm	868mm (Minimum) to 888mm (Maximum)	Standard Profile Tray
1000mm*1000mm	968mm (Minimum) to 988mm (Maximum)	Standard Profile Tray

**NOTE:** Make sure the correct shower is used on the correct tray.

# 1

Walls out of plumb will not allow for full minimum / maximum options.

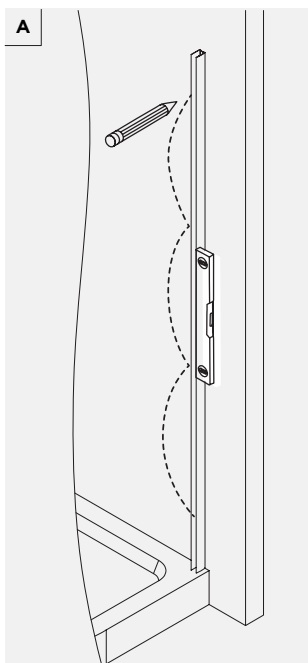
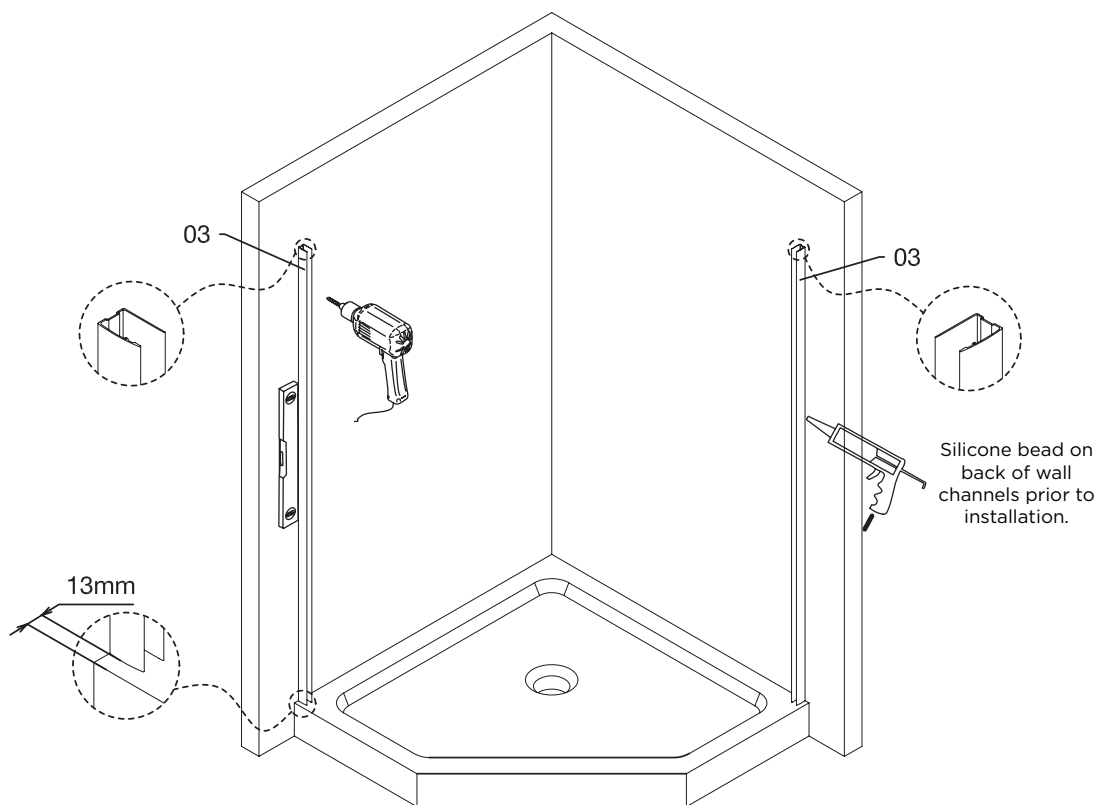

Mark Wall Profile

### Acrylic Shower Layout

Position the wall channels at 13mm off the tray edge as diagram above. This allows for walls bowed or leaning inwards up to 5mm. Reduce the measurement off the tray edge if walls dictate this. Refer to table above.

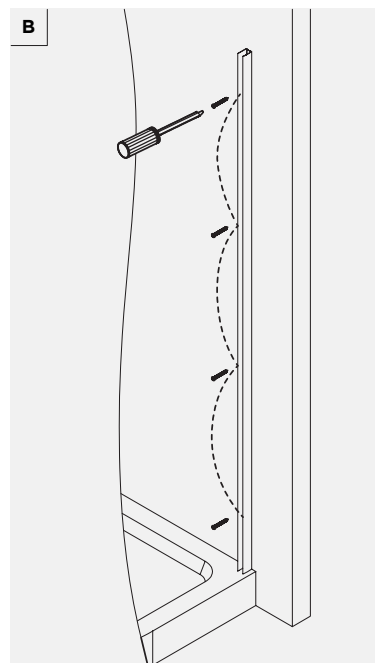

Fasten Profile to wall.

2

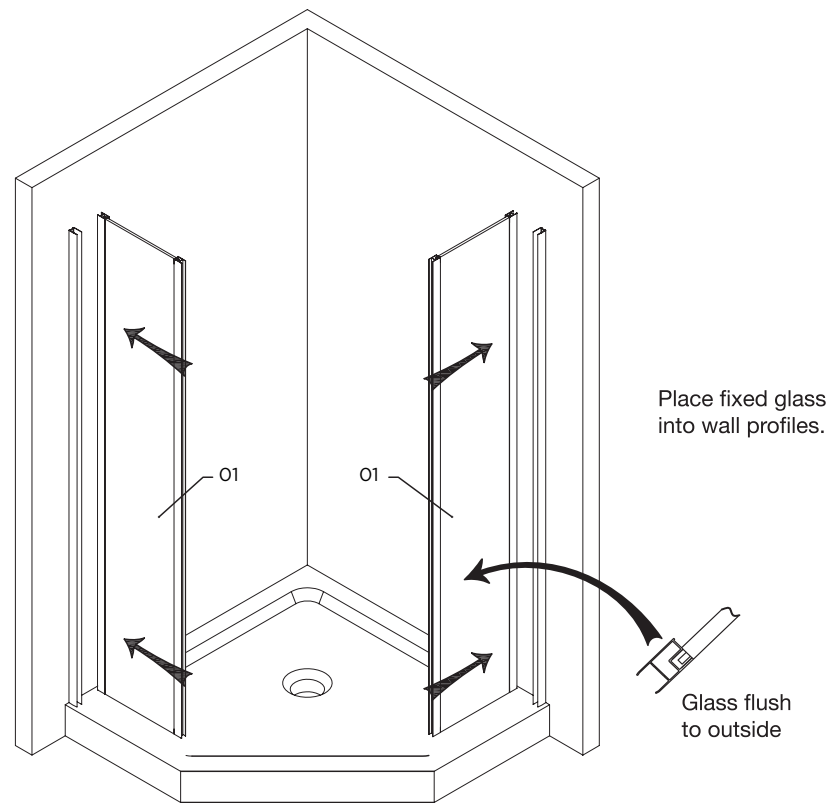

3

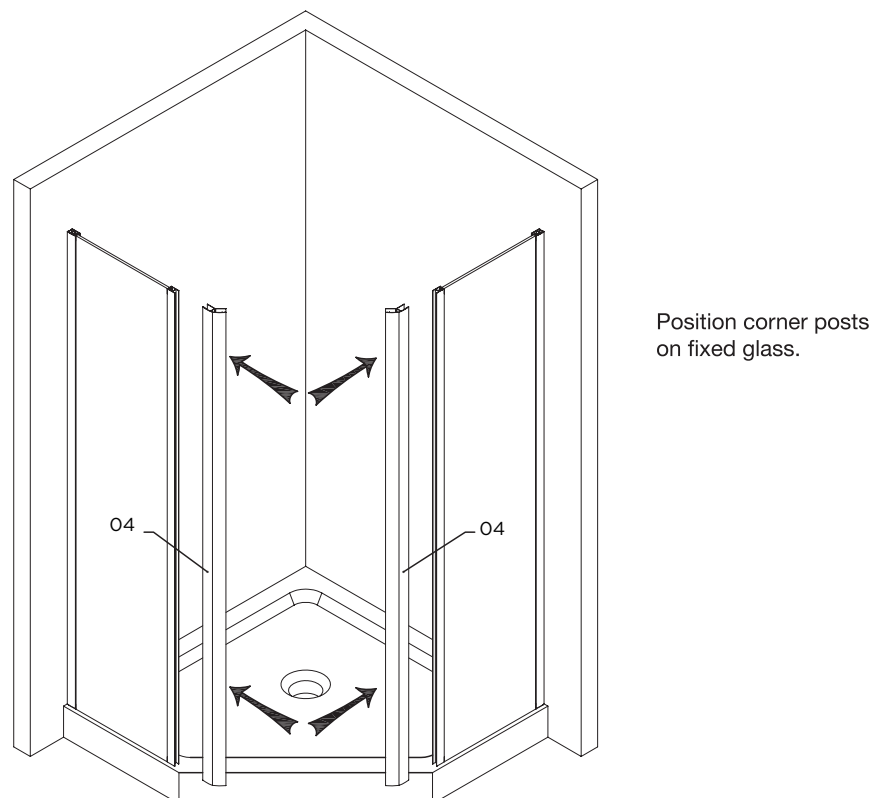

4

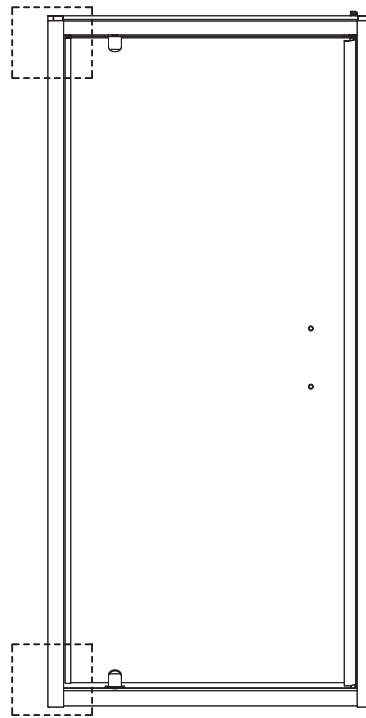
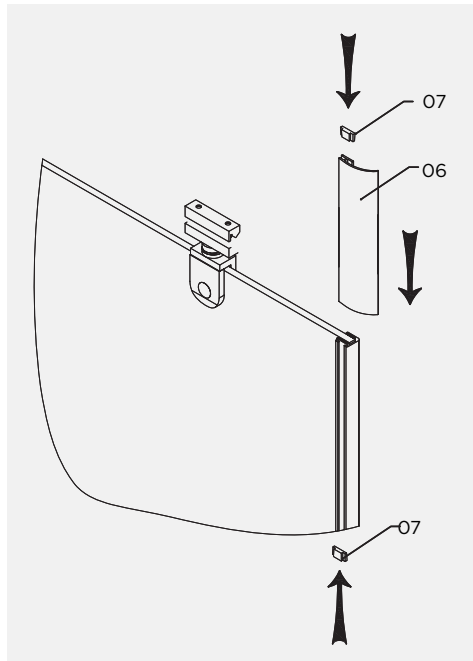

Install back of door seal and  
fix caps top and bottom.  
Always superglue bottom cap.

5

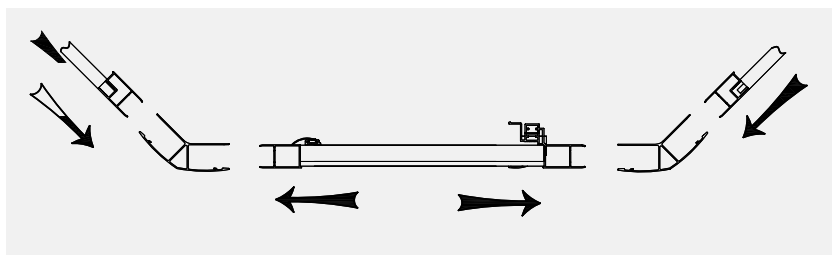
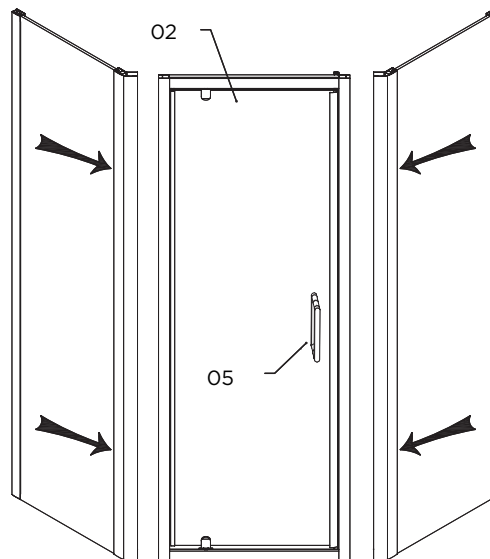
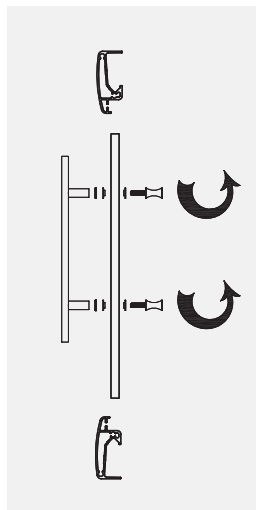

Fit door set to fixed glass.

6

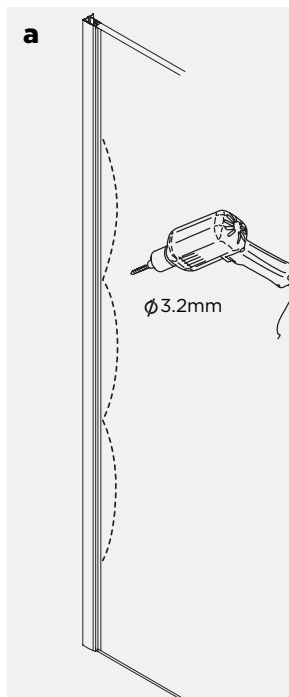

- A. Equalise shower screen to tray edge.
- B. Square up door frame, adjust pivot mounts to align door to frame.
- C. Fit pivot mounting cover caps.
- D. Drill and fasten as indicated.

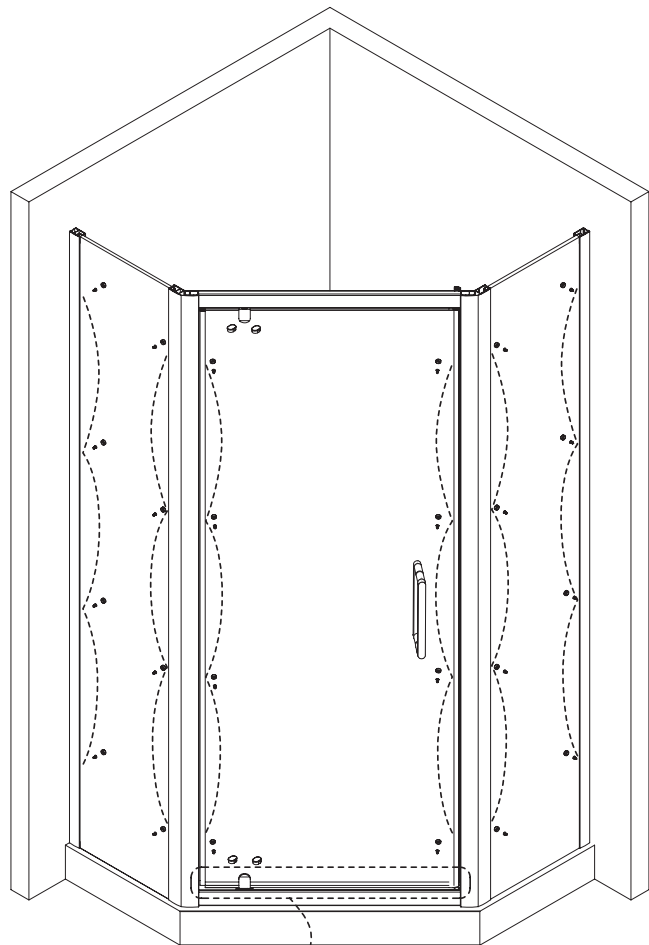

7

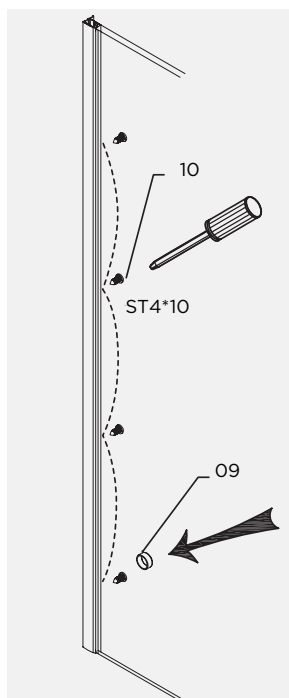

Fastening Parts.

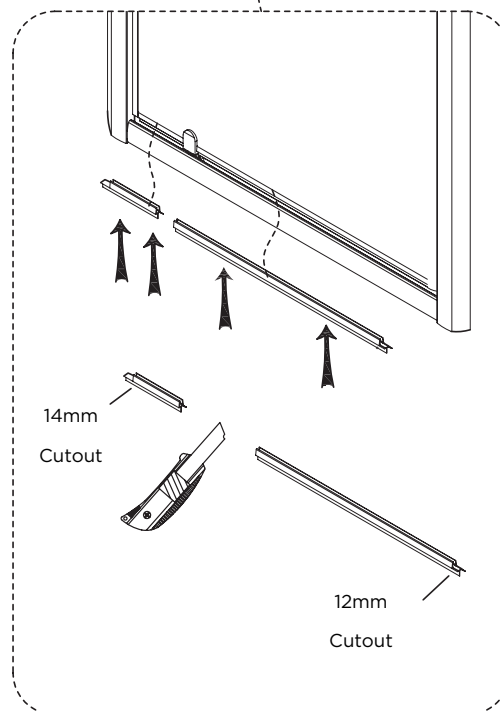

Fit bottom seals.

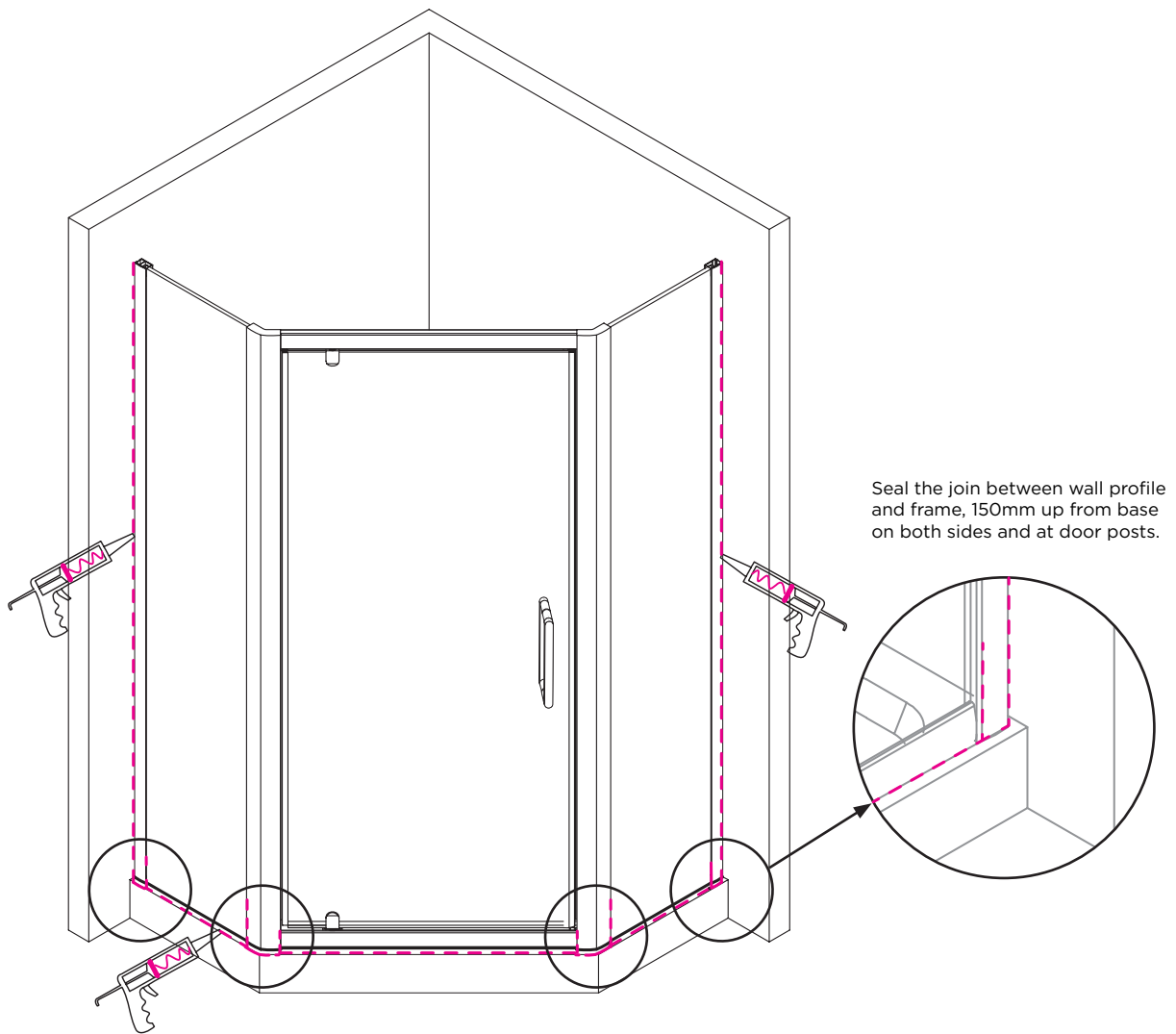

**Allow 24 hours for silicone to dry before use.**